

EXAMPLE

U-SHEET (TWO NOTCH RD) OVER CSX RAILROAD BRIDGE REPLACEMENT P040440 RICHLAND COUNTY, SC

UTILITY RELOCATION PLANS

UTILITY OWNER INFORMATION

SEWER - S1 (ERC) EAST RICHLAND CTY PUBLIC SERVICE 122 ROSS ROAD COLUMBIA SC 29223 BOBBY FRAWL: 803-765-1570 bobbyf@ercpsd.net	TELEPHONE - T1/DB1 (ATT) AT&T 34 WILLIAMS STREET COLUMBIA SC, 29201 HARREL SHOOP: 803-224-9296 shoope.harrel.m@att.com
POWER - OH1/E1 (DE) DOMINION ENERGY (F.K.A. SCE&G)(SCE) 681 FARROW RD COLUMBIA SC 29016 LISA AMBERGHESZK: 803-222-4517 lisaamber@dominionenergy.com CLARK HARRIOT: clarkharri62@dominionenergy.com	FIBER LONG DISTANCE - T2 (VRB) VERIZON BUSINESS 2400 S GLENVILLE DR RICHARDSON TX 75082 BILLY VERNOULLI: 972-777-6322 4412vernou@verizonbusiness.com
WATER - W1 (COC) CITY OF COLUMBIA PO BOX 147 COLUMBIA SC 29217 TOM GROWLER: 803-555-3283 tegrowler@columbiasc.net	FIBER LONG DISTANCE - T3 (TWT) LUMEN (CENTURYLINK, TW TELECOM) 3710 LUCIUS RD COLUMBIA SC 29210 SEAN WRESTLIE: 803-299-1116/803-246-9583 sean.wrestlie@lumen.com
CABLE - TV1 (TWC) CHARTER SPECTRUM (F.K.A. TIME WARNER) 347 PLATT SPRINGS RD WEST COLUMBIA SC 29170 PRESTON REETHER: 803-775-4112 preston.reether@charter.com	FIBER LONG DISTANCE - T4 (LV3) LUMEN (CENTURYLINK COMMUNICATIONS) 3710 LUCIUS RD COLUMBIA SC 29210 GREGORY SMITH: 803-299-1118/803-276-1147 gregory.smith@lumen.com
GAS - G1 (DE) DOMINION ENERGY (F.K.A. SCE&G)(SCE) 55 OLD TAYLOR ROAD CAYCE SC 29033 LUCAS BEEBERRY: 803-777-7272 lucas.beeberry@dominionenergy.com	
TRAFFIC SIGNAL - SIG (DOT) SCDOT 955 PARK ST COLUMBIA SC 29202-0191 CARL HIGGINSWORTH: 803-746-9736 higginsworthcw@dot.stat.sc.us NICK PROWDY: 803-739-5029 prowdynn@scdot.org	

INSTRUCTIONAL GUIDELINE
TITLE SHEET MINIMUM REQUIREMENTS

UTILITY CONTACT INFORMATION
INDEX OF SHEET
PROJECT NAME

CONSULTANT(S) COMPANY LOGOS, ETC.
ON ALL U-SHEETS.

NOTE: U-SHEET WILL FOLLOW DRAFTING
STANDARDS OF THE SCDOT ROADWAY CADD
MANUAL (LATEST EDITION).

INDEX OF SHEETS

DESCRIPTION	SUBTOTAL OF SHEETS
UTILITY TITLE SHEET	U1
UTILITY DATA SHEET	U2
UTILITY POLE DATA SHEET	U3
UTILITY GENERAL NOTES	U4
UTILITY PLAN SHEETS	U5
TOTAL	5

INSTRUCTIONAL GUIDELINE
TITLE SHEET MINIMUM REQUIREMENT

COMPANY LOGOS PLACED HERE ON ALL U-SHEETS

SOUTH CAROLINA
DEPARTMENT OF TRANSPORTATION
ROAD DESIGN COLUMBIA, S.C.

UTILITY TITLE SHEET
US 1 OVER CSX RAILROAD
BRIDGE REPLACEMENT

SCALE = N.T.S. SHEET U1

UTILITY DATA

UTILITY DATA

UTILITY	ALIGNMENT / ROUTE / RD	STATION RANGE	OFFSET	ITEM IN PLACE	OWNERSHIP	REMARKS / MISC NOTES	
W1	US-1 SOUTH OF BRIDGE	164+00-175+00	20-25	L 8	COC	LINE TURNS LEFT SOUTH OF BRIDGE AND TURNS THROUGH RAILROAD RIGHT OF WAY	
W1	US-1 SOUTH OF BRIDGE	164+00-166+00	24-25	L UNK	COC	POSSIBLY OLD ABANDONED WATER LINE	
W1	BAYVIEW DRIVE	N/A		R 4	COC	UNDER PAVEMENT	
W1	FERRELL DRIVE	N/A		L 3 S	COC	UNDER PAVEMENT	
W1	CROSSING TO ALLEY	168+00		R 2 S	COC		
W1	PINESTRAW ROAD	N/A	8-12	R 8 AC	COC	UNDER PAVEMENT	
W1	SATCHEL FORD ROAD	N/A	13	L 8 AC	COC	EDGE PAVEMENT	
W1	ALLBRITTON ROAD	N/A	10-12	R 6	COC	UNDER PAVEMENT	
W1	US-1 NORTH OF BRIDGE	183+00-195+00		L VARIES	COC		
W1	SHAKESPEARE ROAD	N/A	20-25	L 24	COC	EDGE PAVEMENT	
W1	SHAKESPEARE ROAD	N/A		R 8	COC	UNDER PAVEMENT	
W1	FONTAINE ROAD	N/A	18-25	R 24	COC	UNDER PAVEMENT	
W1	ALTA VISTA ROAD	N/A	18-15	R 8	COC	UNDER PAVEMENT	
W1	ALTA VISTA ROAD	N/A	25	R 10	COC		
G1	US-1 SOUTH OF BRIDGE	164+00-176+00	40-45	R 4 P/2 S/2 P	SCG		
G1	US-1 SOUTH OF BRIDGE	164+00-178+00	40-45	L 2 P/2 S	SCG		
G1	US-1 SOUTH OF BRIDGE	164+00-183+00	23	R 6 S AATUR	SCG	UNDER PAVEMENT	
G1	US-1 NORTH OF BRIDGE	183+00-195+00	33-47	L 2 P	SCG	EDGE PAVEMENT	
G1	BAYVIEW DRIVE	N/A	16	R 2 P	SCG		
G1	BAYVIEW DRIVE	N/A	12	R 6 S AATUR	SCG	UNDER PAVEMENT	
G1	FERRELL DRIVE	N/A	14-15	L 2 P	SCG	EDGE PAVEMENT	
G1	ALLEY	NEAR 169+40		R 2 S	SCG	CUTS THROUGH ALLEY	
G1	ALLBRITTON ROAD	N/A	15-20	L 10 S HP	SCG	HIGH PRESSURE	
G1	ALLBRITTON ROAD	N/A	15-20	L 2 S	SCG		
G1	THORNDYKE	N/A	12-14	R 2 P	SCG	RIGHT SIDE COMING FROM ALLBRITTON AT EDGE PAVEMENT	
G1	MALCOME	N/A	12-14	R 2 S	SCG	RIGHT SIDE COMING FROM ALLBRITTON AT EDGE PAVEMENT	
G1	SHAKESPEARE ROAD	N/A	18-20	R 4 P	SCG		
G1	FONTAINE ROAD	N/A	38	R 2 P	SCG	EDGE PAVEMENT	
G1	FONTAINE ROAD	N/A	13	L 6 S AATUR	SCG	UNDER PAVEMENT	
G1	ALTA VISTA ROAD	N/A	20-25	R 2 P	SCG		
G1	ALTA VISTA ROAD	N/A	13-22	L 6 S HP	SCG	HIGH PRESSURE	
G1	US-1 NORTH OF BRIDGE	181+50-184+50	46	R SVC	SCG	CROSSES US-1 AT STATION 184+50 - DESIGNATED BECAUSE OF PROXIMITY TO PROJECT AND CROSSING	
T1	FERRELL DRIVE	N/A	15-18	R C	ATT	UNDER PAVEMENT	
T1	CROSSING	168+25		C	ATT		
T1	US-1 SOUTH OF BRIDGE	168+00-170+00	47-147	R C	ATT	CROSSES US1 & CUTS THROUGH ALLEY	
T1	ALLBRITTON ROAD	N/A		L/R 2 LINES / 1-FO/1-C	ATT	2 LINES ON THE LEFT FOR APPROX. 275' AND CROSSING TO THE RIGHT	
T1	ALLBRITTON ROAD	N/A	15	R FO	ATT	FROM PED APPROX. 190' FROM INTERSECTION	
T1	THORNDYKE	N/A		R C	ATT	RIGHT SIDE COMING FROM ALLBRITTON	
T1	MALCOME	N/A		L C	ATT	LEFT SIDE COMING FROM ALLBRITTON	
T1	ALLBRITTON ROAD	N/A		L C	ATT	120' ON LEFT SIDE QL-C	
T1	CROSSING	180+50		C 2 LINES / 1-FO/1-C	ATT		
T1	CROSSING	188+90		C	ATT		
T1	US-1 NORTH OF BRIDGE	187+50-189+50		L C	ATT		
T1	US-1 NORTH OF BRIDGE	189+50-195+00		L 2 LINES / C	ATT		
T1	SHAKESPEARE ROAD	N/A		L/R MULTIPLE / C	ATT		
T1	FONTAINE ROAD	N/A	40	R C	ATT	STARTS AT PED 300' FROM INTERSECTION US-1 RIGHT SIDE TO ALTA VISTA DRIVE	
T1	ALTA VISTA ROAD	N/A	26	R C	ATT		
T1	ALTA VISTA ROAD	N/A	23	L C	ATT		
DB1	US-1	164+00-190+00		L C/FO	ATT	ATTACHED TO BRIDGE (UNDER)	
DB1	SHAKESPEARE ROAD	N/A	5-10	L C/FO	ATT	UNDER PAVEMENT	
DB1	FONTAINE ROAD	N/A	15-18	L C/FO	ATT		
T2	RAILROAD RIGHT OF WAY	N/A		FO	VRB		
S1	US-1 SOUTH OF BAYVIEW	160+00-163+00		R	ERC	SEE PLAN SHEETS FOR DETAILS	
S1	BAYVIEW DRIVE	N/A		L	ERC	SEE PLAN SHEETS FOR DETAILS	
S1	FERRELL DRIVE	N/A		R	ERC	SEE PLAN SHEETS FOR DETAILS	
S1	PINESTRAW ROAD	N/A			ERC	SEE PLAN SHEETS FOR DETAILS	
S1	ALLBRITTON ROAD	BETWEEN US-1 AND MALCOM RD		R	ERC	SEE PLAN SHEETS FOR DETAILS	
S1	ALLBRITTON ROAD	ABOVE MALCOM ROAD		R	ERC	SEE PLAN SHEETS FOR DETAILS	
S1	US-1 SOUTH OF BRIDGE	172+75-177+25		L	ERC	SEE PLAN SHEETS FOR DETAILS	
S1	US-1 NORTH OF BRIDGE	188+00-197+00		L/R	ERC	SEE PLAN SHEETS FOR DETAILS	
S1	SHAKESPEARE ROAD	N/A		L	ERC	SEE PLAN SHEETS FOR DETAILS	
S1	FONTAINE ROAD	N/A		R	ERC	SEE PLAN SHEETS FOR DETAILS	
S1	ALTA VISTA ROAD	N/A		R	ERC	SEE PLAN SHEETS FOR DETAILS	
TV1	THROUGHOUT PROJECT	THROUGHOUT PROJECT		L/R	COAX AND FO	TWC	THROUGHOUT ENTIRE PROJECT - MOSTLY AERIAL
SIG	US-1	162+50-183+00		L	FO	DOT	AERIAL
SIG	FONTAINE ROAD	N/A		L	FO	DOT	AERIAL
SIG	SHAKESPEARE ROAD	N/A		L	FO	DOT	AERIAL
OH1	THROUGHOUT PROJECT	THROUGHOUT PROJECT		L/R	3 PH / 1 PH / SVC	SCE	THROUGHOUT ENTIRE PROJECT - AERIAL

* NOT SHOWN ON SUE SHEETS BUT LOCATED ON OVERALL SUE MAP.

**ADDITIONAL SPACE AVAILABLE IF NEEDED
DELETE THIS NOTE BEFORE SUBMITTAL**

FILE PATH | FILE NAME | DATE | USER NAME

FOR INFORMATION ONLY

**INSTRUCTIONAL GUIDELINE
UTILITY DATA SHEET**

UTILITY DATA TABLE TO BE INCLUDED
AS PROVIDED BY SUE PER INDIVIDUAL
PROJECT SCOPE

SOUTH CAROLINA
DEPARTMENT OF TRANSPORTATION
ROAD DESIGN COLUMBIA, S.C.

UTILITY DATA SHEET
US 1 OVER CSX RAILROAD
BRIDGE REPLACEMENT

SCALE = N.T.S. SHEET U2

POLE DATA

POLE DATA

POLE	ALIGNMENT / ROUTE / RD	STATION	OFFSET	OWNER	OWNER No	POLE DATA										REMARKS / MISC NOTES	
						HEIGHT	DIAMETER	MATERIAL	TYPE	PHASE/CIR	GW	ANC					
P001	US-1 (TWO NOTCH ROAD)	162+50	41	L	DOT	-	30.6	11	WOOD	PTF	-	-	-	-	-	SIG	
P002	US-1 (TWO NOTCH ROAD)	163+00	41	R	7666	-	33.3	11	WOOD	PP	3PH	-	-	-	E	TV	FO LIGHT
P003	US-1 (TWO NOTCH ROAD)	164+00	43	L	DOT	-	30.4	11	WOOD	PTF	-	-	-	-	SIG		
P004	US-1 (TWO NOTCH ROAD)	164+50	40	R	2553	-	33.2	12	WOOD	PP	3PH	-	-	-	E	TV	FO LIGHT
P005	US-1 (TWO NOTCH ROAD)	166+30	39	R	2552	-	34.2	12	WOOD	PP	3PH	-	-	-	E	TV	FO LIGHT
P006	US-1 (TWO NOTCH ROAD)	166+80	43	L	DOT	-	31.5	11	WOOD	PTF	-	-	-	-	SIG		
P007	US-1 (TWO NOTCH ROAD)	166+77	45	L	SCE	40124	31.2	8	WOOD	LP	SVC	-	-	-	E		LIGHT
P008	FERRELL DRIVE	22	R	ATT	C37898	-	33.2	10	WOOD	PP	SVC	-	-	-	E		TRANSFORMER
P009	US-1 (TWO NOTCH ROAD)	168+36	121	L	SCE	-	27.7	11	WOOD	PP	3PH	-	-	-	E	T	TV TRANSFORMER LIGHT
P010	US-1 (TWO NOTCH ROAD)	168+33	59	L	SCE	2296	39.3	12	WOOD	PP	3PH	1	1	-	E	T	TV
P011	US-1 (TWO NOTCH ROAD)	168+35	7	L	DOT	-	20.0	11	WOOD	TP	-	-	1	1	-		FO
P012	US-1 (TWO NOTCH ROAD)	168+44	4	L	DOT	-	31.4	13	WOOD	PTF	-	-	-	-	SIG		
P013	US-1 (TWO NOTCH ROAD)	169+12	9	R	SCE	5208	40.6	13	WOOD	PP	3PH	-	-	-	E	T	TV FO LIGHT
P014	US-1 (TWO NOTCH ROAD)	168+04	23	R	ATT	C80100	33.1	11	WOOD	PP	3PH	-	-	-	E	T	TV
P015	US-1 (TWO NOTCH ROAD)	167+88	74	L	SCE	227222	24.5	11	WOOD	PP	SVC	-	-	-	E	T	TV LIGHT
P016	US-1 (TWO NOTCH ROAD)	167+87	235	R	ATT	22639	35.1	12	WOOD	PP	3PH	-	-	-	E	T	TV
P017	US-1 (TWO NOTCH ROAD)	170+68	128	R	SCE	2551	32.6	11	WOOD	PP	3PH	-	-	-	E	T	TV FO
P018	US-1 (TWO NOTCH ROAD)	170+64	46	R	ATT	-	28.9	10	WOOD	PP	SVC	-	-	-			TV
P019	US-1 (TWO NOTCH ROAD)	170+42	45	L	DOT	-	28.8	11	WOOD	PTF	-	-	-	-	SIG		
P020	US-1 (TWO NOTCH ROAD)	172+23	46	L	DOT	-	29.2	11	WOOD	PTF	-	-	2	2	SIG		
P021	US-1 (TWO NOTCH ROAD)	172+43	73	L	SCE	10965	28.6	10	WOOD	PP	SVC	1	1	-	E		LIGHT-2
P022	ALLBRITTON ROAD	20+83	121	L	SCE	546606	28.3	11	WOOD	PP	SVC	-	-	-	E		LIGHT
P023	ALLBRITTON ROAD	20+80	108	L	SCE	-	15.3	5	WOOD	MP	SVC	-	-	-	E		LIGHT METER
P024	ALLBRITTON ROAD	22+68	103	L	-	-	34.9	0	WOOD	PP	-	-	-	-			
P025	ALLBRITTON ROAD	22+42	68	L	SCE	482438	30.0	11	WOOD	LP	SVC	-	-	-	E		LIGHT
P026	ALLBRITTON ROAD	22+65	21	R	SCE	C8716	34.3	12	WOOD	PP	3PH	-	-	-	E	T	TV TRANSFORMER
P027	ALLBRITTON ROAD	21+55	47	L	SCE	-	17.0	4	WOOD	MP	SVC	-	-	-	E	T	TV LIGHT-2 METER
P028	ALLBRITTON ROAD	24+39	139	L	ATT	C8722	34.1	12	WOOD	PP	3PH	-	-	-	E	T	TV TRANSFORMER
P029	ALLBRITTON ROAD	24+52	26	R	SCE	43657	29.2	11	WOOD	LP	SVC	-	-	-	E		
P030	ALLBRITTON ROAD	N/S	N/S	R	-	-	30.6	N/S	WOOD	PP	-	-	-	-			
P031	ALLBRITTON ROAD	173+03	60	L	-	-	15.9	5	WOOD	MP	SVC	-	-	-	E		METER
P032	ALLBRITTON ROAD	173+01	59	L	-	-	29.3	11	WOOD	PP	SVC	-	-	-	E		LIGHT
P033	US-1 (TWO NOTCH ROAD)	172+91	44	L	DOT	-	29.7	11	WOOD	PTF	-	-	2	2	SIG		TRANSFORMER
P034	US-1 (TWO NOTCH ROAD)	172+06	44	R	SCE	2848	41.2	12	WOOD	PP	3PH	-	-	-	E	TV	FO
P035	US-1 (TWO NOTCH ROAD)	172+76	43	R	SCE	631753	38.7	11	WOOD	PP	3PH	-	-	-	E	TV	FO
P036	US-1 (TWO NOTCH ROAD)	172+76	50	R	DOT	-	27.4	11	WOOD	PTF	SVC	2	2	SIG			
P037	PINESTRAW ROAD	12+51	27	L	SCE	C5423	33.5	11	WOOD	PP	3PH	2	1	-	E	T	TV TRANSFORMER
P038	PINESTRAW ROAD	13+20	26	L	SCE	46104	39.6	12	WOOD	PP	3PH	2	1	-	E	T	TV TRANSFORMER
P039	PINESTRAW ROAD	13+58	91	R	SCE	230700	33.0	12	WOOD	PP	1PH	-	-	-	E		
P040	PINESTRAW ROAD	13+55	26	L	SCE	344662	39.4	12	WOOD	PP	3PH	-	-	-	E	T	TV TRANSFORMER
P041	PINESTRAW ROAD	14+86	25	L	-	-	23.9	10	WOOD	OP	-	-	-	-			TRANSFORMER
P042	PINESTRAW ROAD	14+91	25	L	ATT	C5018	38.9	12	WOOD	PP	3PH	-	-	-	E	T	TV
P043	PINESTRAW ROAD	16+22	17	L	SCE	18050	32.1	12	WOOD	PP	3PH	-	-	-	E	T	TV LIGHT
P044	US-1 (TWO NOTCH ROAD)	174+17	42	R	SCE	2550	32.2	11	WOOD	PP	3PH	1	1	-	E	TV	FO
P045	US-1 (TWO NOTCH ROAD)	174+24	325	R	SCE	115301	32.7	11	WOOD	PP	3PH	-	-	-	E		TRANSFORMER-3
P046	US-1 (TWO NOTCH ROAD)	174+50	154	R	SCE	452157	28.5	11	WOOD	LP	SVC	-	-	-	E	TV	FO LIGHT
P047	US-1 (TWO NOTCH ROAD)	175+87	44	L	DOT	-	29.4	11	WOOD	PTF	-	-	-	-	SIG		LIGHT-2
P048	US-1 (TWO NOTCH ROAD)	175+53	193	L	SCE	C5291	29.8	11	WOOD	PP	SVC	-	-	-	E		
P049	US-1 (TWO NOTCH ROAD)	176+08	44	R	SCE	0313706	38.9	11	WOOD	PP	3PH	-	-	-	E	TV	FO TRANSFORMER
P050	US-1 (TWO NOTCH ROAD)	177+21	236	R	-	-	40.7	11	WOOD	PP	-	-	-	-	E	TV	FO
P051	US-1 (TWO NOTCH ROAD)	177+66	43	R	SCE	26146	38.7	12	WOOD	PP	3PH	-	-	-	E	TV	FO TRANSFORMER-3
P052	US-1 (TWO NOTCH ROAD)	178+95	47	R	SCE	42636	43.5	13	WOOD	PP	3PH	3	2	-	E	TV	FO TRANSFORMER-2
P053	US-1 (TWO NOTCH ROAD)	178+98	48	R	ATT	-	24.4	12	WOOD	TP	-	-	1	1	-	T	
P054	US-1 (TWO NOTCH ROAD)	178+97	43	L	DOT	-	30.4	11	WOOD	TFP	-	-	-	-	SIG		
P055	US-1 (TWO NOTCH ROAD)	178+94	44	L	SCE	568018	27.8	11	WOOD	PP	SVC	3	3	-	E	TV	
P056	US-1 (TWO NOTCH ROAD)	178+57	74	L	SCE	-	27.3	11	WOOD	PP	SVC	-	-	-	E		LIGHT
P057	US-1 (TWO NOTCH ROAD)	178+76	136	L	SCE	222363	24.5	11	WOOD	PP	SVC	-	-	-	E		
P058	US-1 (TWO NOTCH ROAD)	180+29	47	L	DOT	-	30.5	11	WOOD	TFP	-	-	-	-	SIG		LIGHT
P059	US-1 (TWO NOTCH ROAD)	180+27	171	L	SCE	5253	32.2	11	WOOD	PP	SVC	1	1	-	E	T	
P060	US-1 (TWO NOTCH ROAD)	180+78	50	R	SCE	C952	43.4	11	WOOD	PP	3PH	-	-	-	E	TV	FO TRANSFORMER LIGHT
P061	US-1 (TWO NOTCH ROAD)	181+92	83	L	SCE	-	29.6	11	WOOD	LP	SVC	1	1	-	E		LIGHT
P062	FONTAINE ROAD	02+28	41	L	DOT	-	27.5	11	WOOD	TFP	-	-	-	-	SIG		TRANSFORMER
P063	FONTAINE ROAD	02+87	87	L	SCE	592120	33.8	12	WOOD	PP	3PH	-	-	-	E	TV	TRANSFORMER-3 LIGHT
P064	FONTAINE ROAD	04+91	34	L	SCE	245243	27.3	11	WOOD	TFP	-	-	1	1	SIG		TRANSFORMER
P065	FONTAINE ROAD	06+04	39	L	-	-	30.4	11	WOOD	TFP	-	-	1	1	SIG		TRANSFORMER
P066	FONTAINE ROAD	06+01	34	L	SCE	353380	30.0	11	WOOD	LP	SVC	1	1	-	E		LIGHT
P067	FONTAINE ROAD	07+40	60	L	SCE	516694	35.9	12	WOOD	GP	-	-	1	1	-		
P068	FONTAINE ROAD	08+41	39	L	SCE	245241	29.5	11	WOOD	GP	-	-	1	1	-		
P069	FONTAINE ROAD	08+99	37	L	SCE	516695	25.0	11	WOOD	GP	-	-	1	1	-		
P070	FONTAINE ROAD	10+00	37	L	SCE	270675	24.0	10	WOOD	GP	-	-	1	1	-		

EXAMPLE SHEET

ADDITIONAL SPACE AVAILABLE IF NEEDED
DELETE THIS NOTE BEFORE SUBMITTAL

[FILE PATH] [FILE NAME]
[DATE] [USER NAME]

FOR INFORMATION ONLY

INSTRUCTIONAL GUIDELINE
POLE DATA SHEET

POLE DATA SHEET TO BE INCLUDED
AS PROVIDED BY SUE PER INDIVIDUAL
PROJECT SCOPE

SOUTH CAROLINA
DEPARTMENT OF TRANSPORTATION
ROAD DESIGN COLUMBIA, S.C.

POLE DATA SHEET
US 1 OVER CSX RAILROAD
BRIDGE REPLACEMENT

SCALE = N.T.S. SHEET U3

STATE	COUNTY	PROJECT ID	ROUTE NO.	SHEET NO.
S.C.	RICHLAND	P040440	US-1	U4

EXAMPLE U-SHEET

INSTRUCTIONAL GUIDELINE

UTILITY GENERAL NOTES SHEET MAY INCLUDE DATA CONCERNING THE FOLLOWING
(AS EXAMPLE ONLY - INDIVIDUAL PROJECTS WILL DICTATE REQUIRED NOTES)

PROJECT SPECIFIC NOTES (EXAMPLE: UTILITY CONFLICT SUMMARY)

STANDARD LANGUAGE

SPECIAL PROVISIONS

SC-811 REQUIREMENTS

UTILITY AS-BUILT NOTES

UTILITY STAKING NOTES

UTILITY RELOCATION INCIDENTALS

UTILITY RELOCATION SCHEDULE MAY INCLUDE:

UTILITY RELOCATION WINDOW

UTILITY RELOCATION SEQUENCE

UTILITY RELOCATION TIMEFRAMES

[FILE PATH] [FILE NAME]
[DATE] [USER NAME]

SOUTH CAROLINA
DEPARTMENT OF TRANSPORTATION
ROAD DESIGN COLUMBIA, S.C.

UTILITY GENERAL NOTES SHEET
US 1 OVER CSX RAILROAD
BRIDGE REPLACEMENT

SCALE = N.T.S

SHEET U4

EXAMPLE U-SHEET

FOR INFORMATION ONLY

STATE	COUNTY	PROJECT ID	ROUTE	SHEET NO.
S.C.	RICHLAND	P040440	US-1	U5

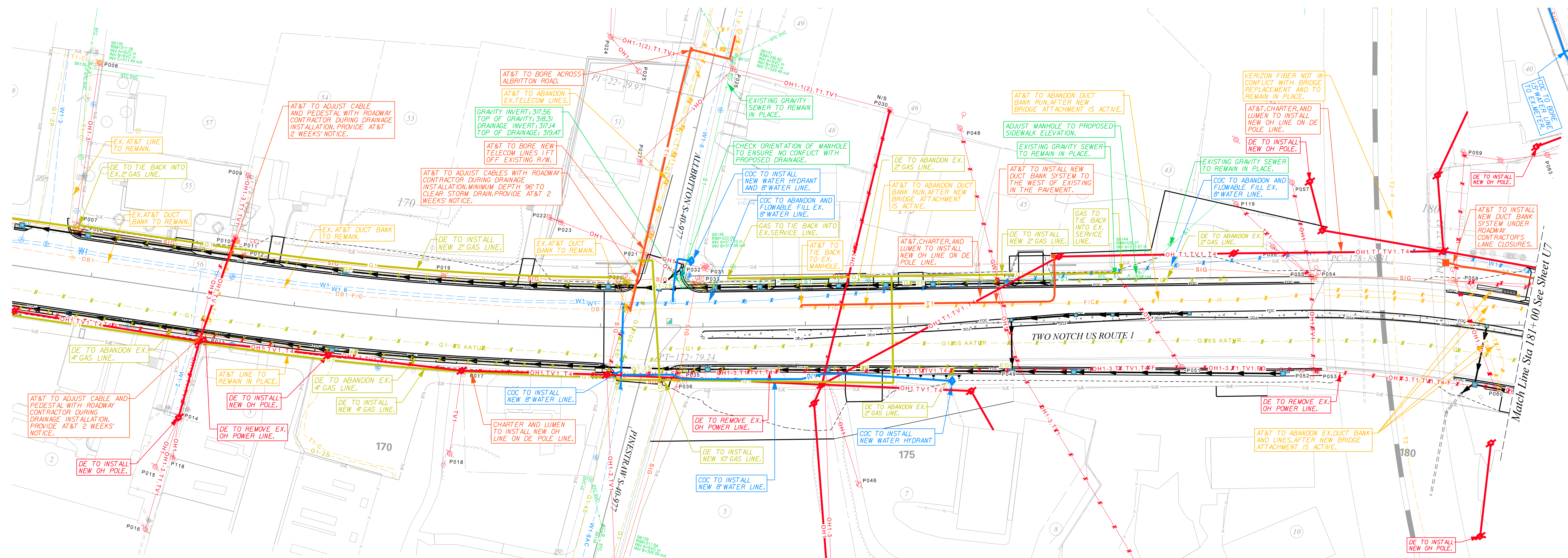

U SHEET LEGEND

PROPOSED UTILITY LINES		REMOVED UTILITIES	
E1 THRU E10	ELECTRIC	E	ELECTRIC
TF1 THRU TF5	TRAFFIC CONTROL	TF	TRAFFIC CONTROL
T1 THRU T10	TELEPHONE	T	TELEPHONE
TV1 THRU TV10	CABLE TV	TV	CABLE TV
I1 THRU I10	IRRIGATION	I	IRRIGATION
R1 THRU R10	SLURRY	R	SLURRY
G1 THRU G10	GAS	G	GAS
F1 THRU F5	FUEL / PETROLEUM	F	FUEL / PETROLEUM
ST1 THRU ST5	STEAM	ST	STEAM
CA1 THRU CA5	COMPRESSED GAS	CA	COMPRESSED GAS
W1 THRU W10	WATER	W	WATER
S1 THRU S10	GRAVITY SEWER	S	GRAVITY SEWER
FS1 THRU FS10	FORCED SEWER	FS	FORCED SEWER
SIG	AERIAL SIGNAL	SIG	AERIAL SIGNAL
OH1 THRU OH20	AERIAL UTILITIES	OH	AERIAL UTILITIES
GW	AERIAL GUY WIRE	GW	AERIAL GUY WIRE
M1 THRU M5	MISCELLANEOUS	M	MISCELLANEOUS
DB1 THRU DB5	DUCT BANK	DB	DUCT BANK
TNL	UTILITY TUNNEL	TNL	UTILITY TUNNEL

INSTRUCTIONAL GUIDELINE UTILITY RELOCATION PLANS MINIMUM REQUIREMENTS

- EXISTING AND PROPOSED UTILITIES (EXISTING WILL BE SMALLER LINEWEIGHT THAN PROPOSED)
- EXISTING ROADWAY AND DRAINAGE
- EXISTING AND PROPOSED ROW AND UTILITY EASEMENTS
- EXISTING PROPERTY LINES (NO PROPERTY INFO EXCEPT PROPERTY NUMBER)
- BASELINE / CENTERLINE AND STATION NUMBERS
- PROPOSED ROADWAY, DRAINAGE AND STRUCTURES (INCLUDING WALLS, BRIDGES, EARTHQUAKE DRAINS, ETC.)
- LIMITS OF CONSTRUCTION AND NPDES
- PROPOSED SIGNALS, OH SIGNS, AND CABINETS (AT LEAST FOUNDATIONS OR FOUNDATION BOX TO SHOW SIZE)
- TEST HOLE DATA, IF APPLICABLE - SHOW WITH CALLOUTS OR TABLE ON U-SHEETS
- MOT / TRAFFIC CONTROL - CALL OUT IN NOTES ON U-SHEET IF SOMETHING CONTRACTOR NEEDS TO BE AWARE REFERENCE U5 FOR FURTHER INFORMATION AS NEEDED

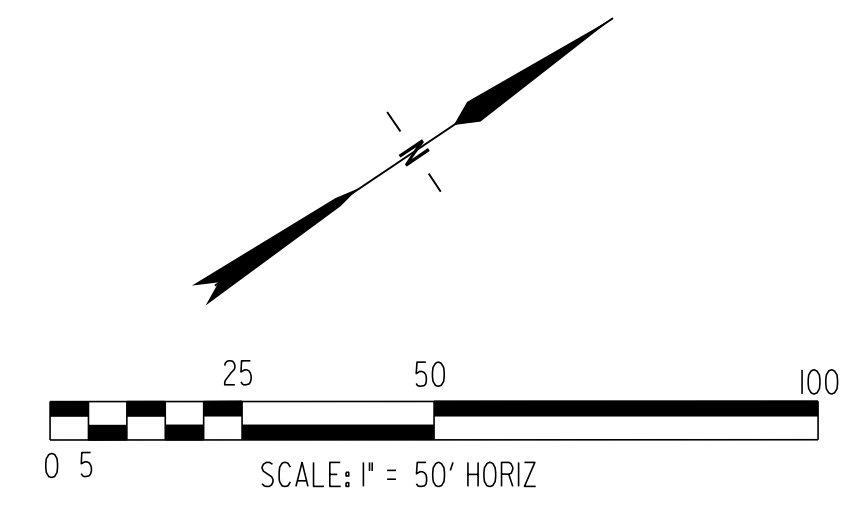

SOUTH CAROLINA
DEPARTMENT OF TRANSPORTATION
ROAD DESIGN COLUMBIA, S.C.

US 1(TWO NOTCH ROAD)
UTILITY PLAN SHEET
STA 165+50 TO STA 181+00

SCALE 1" = 50' SHEET U5

FILE PATH\FILE NAME\ [DATE] [USER NAME]