

I-26 Mainline

Chain I26RA1P contains:

PI26001 CUR I26RA1P-1 CUR I26RA1P-2 CUR I26RA1P-3 CUR I26RA1P-4 CUR I26RA1P-5 -
CUR I26RA1P-6 CUR I26RA1P-7 CUR I26RA1P-8 CUR I26RA1P-9 PI26002

Beginning chain I26RA1P description

=====

Point PI26001 N 827,563.3952 E 1,944,332.8776 Sta 0+00.00

Course from PI26001 to PC I26RA1P-1 S 40° 33' 48.59" E Dist 3,055.6752

Curve Data

Curve I26RA1P-1

P.I. Station	32+46.44	N	825,097.1196	E	1,946,444.0075
Delta	=	1° 54' 26.97"	(LT)		
Degree	=	0° 30' 00.00"			
Tangent	=	190.7668			
Length	=	381.4983			
Radius	=	11,459.1560			
External	=	1.5878			
Long Chord	=	381.4807			
Mid. Ord.	=	1.5876			
P.C. Station	30+55.68	N	825,242.0423	E	1,946,319.9537
P.T. Station	34+37.17	N	824,956.4063	E	1,946,572.8164
C.C.		N	832,693.8211	E	1,955,025.3112
Back	= S	40° 33' 48.59"	E		
Ahead	= S	42° 28' 15.56"	E		
Chord Bear	= S	41° 31' 02.08"	E		

Max SE = 8%
Design SE = RC

Course from PT I26RA1P-1 to PC I26RA1P-2 S 42° 28' 15.56" E Dist 5,262.6226

I-26_Exit101_BroadRiver_at_I-26_(BRD001P)

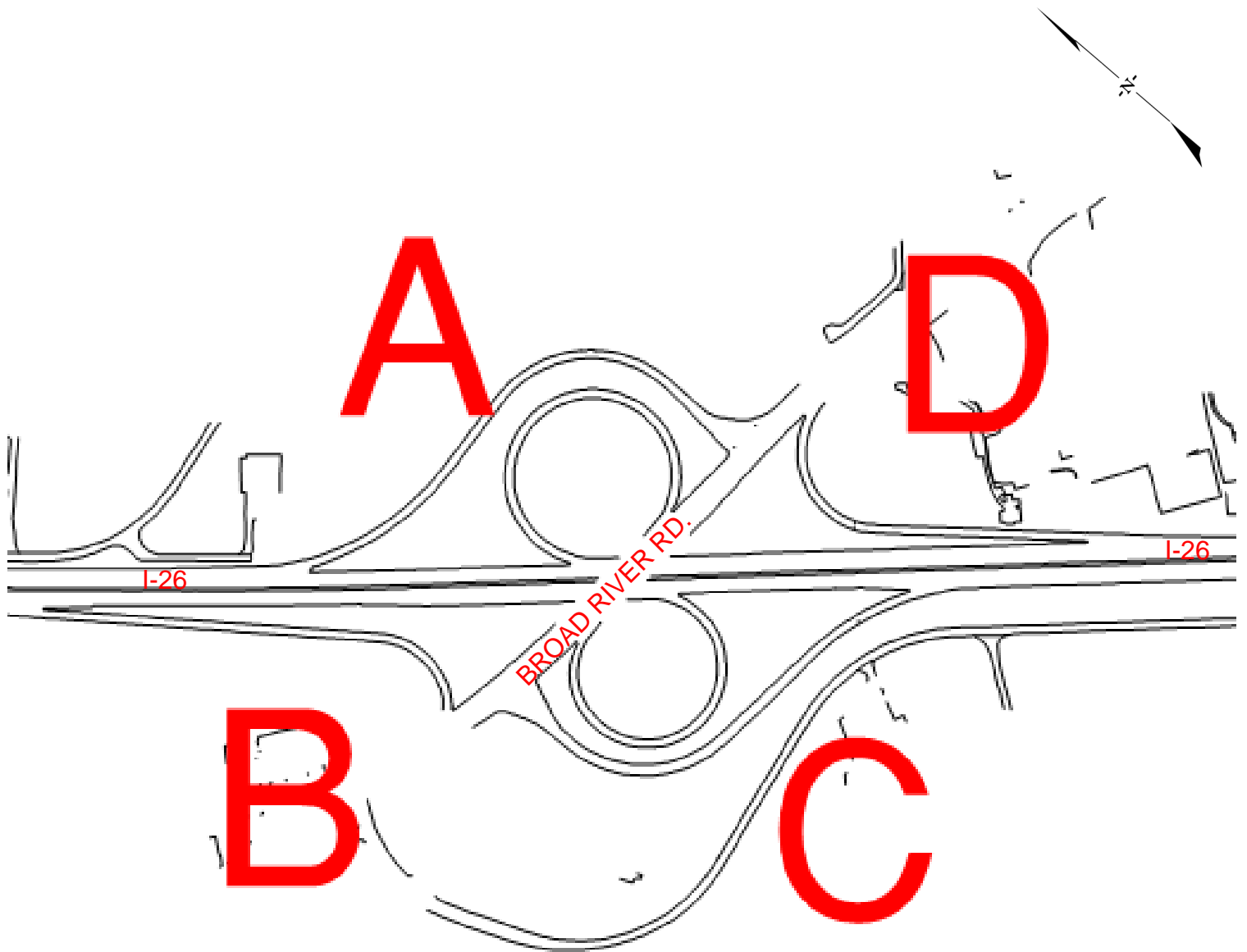

Copyright: (c) 2012 Bentley Systems, Incorporated. All rights reserved.

Project: PA_BRDI26_MB

Subject:

Job No. PA Operator: MB

Date: Friday May 11, 2018 10:11 am

SYSTEM FIX 4 ASEC 2 BEAR PRI 0 NOR NE STA 2 FILE: 'RPA_BRD_I26'

* 1 DESCRIBE CHAIN BRDLA0P

Chain BRDLA0P contains:

CUR BRDLA0P-C1 CUR BRDLA0P-C2

Beginning chain BRDLA0P description

Curve Data

Curve BRDLA0P-C1

P.I. Station	3035+64.06	N	824,367.2974	E	1,948,081.7848
Delta	= 146° 53' 42.79"	(LT)			
Degree	= 22° 55' 05.92"				
Tangent	= 841.1607				
Length	= 640.9513				
Radius	= 250.0000				
External	= 627.5256				
Long Chord	= 479.2798				
Mid. Ord.	= 178.7770				
P.C. Station	3027+22.90	N	824,432.1851	E	1,947,243.1306
P.T. Station	3033+63.86	N	824,879.7014	E	1,947,414.7065
C.C.		N	824,681.4401	E	1,947,262.4158
Back	= S 85° 34' 32.77" E				
Ahead	= N 52° 28' 15.56" W				
Chord Bear	= N 20° 58' 35.83" E				

Max SE = 8.0%
 Design SE = 8.0%

Curve Data

Curve BRDLA0P-C2

P.I. Station	3062+21.37	N	826,620.3928	E	1,945,148.5701
Delta	= 170° 00' 00.00"	(LT)			
Degree	= 22° 55' 05.92"				
Tangent	= 2,857.5131				
Length	= 741.7649				
Radius	= 250.0000				
External	= 2,618.4283				
Long Chord	= 498.0973				
Mid. Ord.	= 228.2111				
P.C. Station	3033+63.86	N	824,879.7014	E	1,947,414.7065
P.T. Station	3041+05.62	N	824,512.6359	E	1,947,078.0109
C.C.		N	824,681.4401	E	1,947,262.4158
Back	= N 52° 28' 15.56" W				
Ahead	= S 42° 28' 15.56" E				
Chord Bear	= S 42° 31' 44.44" W				

Max SE = 8.0%
 Design SE = 8.0%

Ending chain BRDLA0P description

* 2 DESCRIBE CHAIN BRDLC0P

Chain BRDLC0P contains:

CUR BRDLC0P-C1 CUR BRDLC0P-C2

Beginning chain BRDLC0P description

```

=====
                        Curve Data
                        *-----*
Curve BRDLC0P-C1
P.I. Station      5071+49.50  N      822,168.8285  E      1,949,025.5985
Delta =          170° 00' 00.00" (RT)
Degree =          22° 55' 05.92"
Tangent =          2,857.5131
Length =           741.7649
Radius =           250.0000
External =          2,618.4283
Long Chord =          498.0973
Mid. Ord. =          228.2111
P.C. Station      5042+91.99  N      824,276.5853  E      1,947,096.1576
P.T. Station      5050+33.75  N      823,909.5199  E      1,946,759.4620
C.C.              N      824,107.7811  E      1,946,911.7528
Back = S 42° 28' 15.56" E
Ahead = N 52° 28' 15.56" W
Chord Bear = S 42° 31' 44.44" W

```

```

=====
                        Curve Data
                        *-----*
Curve BRDLC0P-C2
P.I. Station      5058+74.92  N      824,421.9239  E      1,946,092.3837
Delta =          146° 53' 42.79" (RT)
Degree =          22° 55' 05.92"
Tangent =          841.1607
Length =           640.9513
Radius =           250.0000
External =          627.5256
Long Chord =          479.2798
Mid. Ord. =          178.7770
P.C. Station      5050+33.75  N      823,909.5199  E      1,946,759.4620
P.T. Station      5056+74.71  N      824,357.0362  E      1,946,931.0379
C.C.              N      824,107.7811  E      1,946,911.7528
Back = N 52° 28' 15.56" W
Ahead = S 85° 34' 32.77" E
Chord Bear = N 20° 58' 35.83" E

```

Ending chain BRDLC0P description

* 3 DESCRIBE CHAIN BRDRA0P

Chain BRDRA0P contains:

CUR BRDRA0P-C1 CUR BRDRA0P-C2 BRDPRA0004

Beginning chain BRDRA0P description

```

=====
                        Curve Data
                        *-----*
Curve BRDRA0P-C1
P.I. Station      3034+27.19  N      825,007.2790  E      1,946,617.0033
Delta =          53° 00' 27.92" (LT)
Degree =           5° 43' 46.48"
Tangent =          498.6661
Length =           925.1599

```

Radius	=	1,000.0000			
External	=	117.4381			
Long Chord	=	892.5168			
Mid. Ord.	=	105.0958			
P.C. Station		3029+28.52	N	825,386.1086	E 1,946,292.7255
P.T. Station		3038+53.68	N	825,038.3408	E 1,947,114.7011
C.C.			N	826,036.3989	E 1,947,052.4113
Back	= S	40° 33' 48.59"	E		
Ahead	= N	86° 25' 43.48"	E		
Chord Bear	= S	67° 04' 02.56"	E		

Course from PT BRDRA0P-C1 to PC BRDRA0P-C2 N 86° 25' 43.48" E Dist 147.3420

Curve Data

Curve BRDRA0P-C2					
P.I. Station		3044+25.12	N	825,073.9359	E 1,947,685.0346
Delta	=	99° 30' 15.96"	(RT)		
Degree	=	15° 57' 35.38"			
Tangent	=	424.1012			
Length	=	623.4681			
Radius	=	359.0000			
External	=	196.6463			
Long Chord	=	548.0189			
Mid. Ord.	=	127.0521			
P.C. Station		3040+01.02	N	825,047.5187	E 1,947,261.7569
P.T. Station		3046+24.49	N	824,652.1066	E 1,947,641.1958
C.C.			N	824,689.2159	E 1,947,284.1190
Back	= N	86° 25' 43.48"	E		
Ahead	= S	5° 55' 59.44"	W		
Chord Bear	= S	43° 49' 08.54"	E		

Course from PT BRDRA0P-C2 to BRDPRA0004 S 5° 55' 59.44" W Dist 311.5812

Point BRDPRA0004 N 824,342.1944 E 1,947,608.9881 Sta 3049+36.07

=====

Ending chain BRDRA0P description

* 4 DESCRIBE CHAIN BRDRB0P

Chain BRDRB0P contains:
BRDPRB0001 CUR BRDRB0P-C1 BRDPRB0003

Beginning chain BRDRB0P description

=====

Point BRDPRB0001 N 825,913.0691 E 1,945,665.2590 Sta 4021+20.16

Course from BRDPRB0001 to PC BRDRB0P-C1 S 36° 32' 00.93" E Dist 1,328.4628

Curve Data

Curve BRDRB0P-C1					
P.I. Station		4036+65.06	N	824,671.7333	E 1,946,584.9260
Delta	=	87° 31' 20.63"	(RT)		
Degree	=	25° 21' 07.61"			
Tangent	=	216.4326			
Length	=	345.2272			
Radius	=	226.0000			
External	=	86.9202			
Long Chord	=	312.6277			

Mid. Ord.	=	62.7763			
P.C. Station		4034+48.62	N	824,845.6386	E 1,946,456.0849
P.T. Station		4037+93.85	N	824,535.4950	E 1,946,416.7529
C.C.			N	824,711.1022	E 1,946,274.4921
Back	= S	36° 32' 00.93"	E		
Ahead	= S	50° 59' 19.69"	W		
Chord Bear	= S	7° 13' 39.38"	W		

Course from PT BRDRB0P-C1 to BRDPRB0003 S 50° 59' 19.69" W Dist 41.3208

Point BRDPRB0003 N 824,509.4847 E 1,946,384.6456 Sta 4038+35.17

=====

Ending chain BRDRB0P description

* 5 DESCRIBE CHAIN BRDRC0P

Chain BRDRC0P contains:

BRDPRC0001 CUR BRDRC0P-C1 CUR BRDRC0P-C2

Beginning chain BRDRC0P description

=====

Point BRDPRC0001 N 824,430.8886 E 1,946,668.2651 Sta 5035+68.31

Course from BRDPRC0001 to PC BRDRC0P-C1 S 23° 13' 43.04" W Dist 129.7011

Curve Data

Curve BRDRC0P-C1

P.I. Station		5041+86.20	N	823,863.0870	E 1,946,424.5692
Delta	=	106° 53' 05.19"	(LT)		
Degree	=	15° 49' 39.23"			
Tangent	=	488.1875			
Length	=	675.3078			
Radius	=	362.0000			
External	=	245.7590			
Long Chord	=	581.5590			
Mid. Ord.	=	146.3817			
P.C. Station		5036+98.02	N	824,311.7013	E 1,946,617.1109
P.T. Station		5043+73.32	N	823,809.1447	E 1,946,909.7674
C.C.			N	824,168.9281	E 1,946,949.7666
Back	= S	23° 13' 43.04"	W		
Ahead	= S	83° 39' 22.14"	E		
Chord Bear	= S	30° 12' 49.55"	E		

Max SE = 8.0%
Design SE = 7.0%

Course from PT BRDRC0P-C1 to PC BRDRC0P-C2 S 83° 39' 22.14" E Dist 312.3705

Curve Data

Curve BRDRC0P-C2

P.I. Station		5050+61.42	N	823,733.1134	E 1,947,593.6519
Delta	=	41° 11' 06.58"	(RT)		
Degree	=	5° 43' 46.48"			
Tangent	=	375.7275			
Length	=	718.8167			
Radius	=	1,000.0000			
External	=	68.2561			
Long Chord	=	703.4409			
Mid. Ord.	=	63.8949			
P.C. Station		5046+85.69	N	823,774.6294	E 1,947,220.2251
P.T. Station		5054+04.51	N	823,455.9695	E 1,947,847.3495

Max SE = 8.0%
Design SE = 6.0%

				RPA_BRD_I26pa.omb		
C.C.				N	822,780.7527	E 1,947,109.7301
Back	= S	83° 39'	22.14"	E		
Ahead	= S	42° 28'	15.56"	E		
Chord Bear	= S	63° 03'	48.85"	E		

=====

Ending chain BRDRC0P description

* 6 DESCRIBE CHAIN BRDRD0P

Chain BRDRD0P contains:
BRDPRD0001 CUR BRDRD0P-C1 BRDPRD0003

Beginning chain BRDRD0P description

=====

Point BRDPRD0001	N	824,274.4367	E	1,947,914.0878	Sta 6044+47.75
------------------	---	--------------	---	----------------	----------------

Curve Data

Curve BRDRD0P-C1					
P.I. Station		6049+85.79	N	824,332.4520	E 1,947,379.1830
Delta	=	134° 36'	44.19"	(LT)	
Degree	=	25° 27'	53.25"		
Tangent	=	538.0417			
Length	=	528.6212			
Radius	=	225.0000			
External	=	358.1928			
Long Chord	=	415.1607			
Mid. Ord.	=	138.1934			
P.C. Station		6044+47.75	N	824,274.4367	E 1,947,914.0878
P.T. Station		6049+76.37	N	823,910.9219	E 1,947,713.5499
C.C.			N	824,050.7485	E 1,947,889.8267
Back	= N	83° 48'	35.80"	W	
Ahead	= S	38° 25'	19.99"	E	
Chord Bear	= S	28° 53'	02.10"	W	

Course from PT BRDRD0P-C1 to BRDPRD0003 S 38° 25' 19.99" E Dist 885.1763

Point BRDPRD0003	N	823,217.4283	E	1,948,263.6442	Sta 6058+61.55
------------------	---	--------------	---	----------------	----------------

=====

Ending chain BRDRD0P description

RPA_WSTpa.omb

Copyright: (c) 2012 Bentley Systems, Incorporated. All rights reserved.
 Project: PA_BRDI26_MB
 Subject:
 Job No. PA Operator: MB
 Date: Tuesday May 15, 2018 1:27 pm

SYSTEM FIX 4 ASEC 2 BEAR PRI 0 NOR NE STA 2 FILE: 'RPA_WST'

* 1 DESCRIBE CHAIN WST001P

Chain WST001P contains:
 WST001 WST002 CUR WSTCUR01

Beginning chain WST001P description

Point WST001 N 826,543.2706 E 1,945,338.0375 Sta 10+00.00

Course from WST001 to WST002 S 41° 17' 21.76" E Dist 297.7092

Point WST002 N 826,319.5759 E 1,945,534.4846 Sta 12+97.71

Course from WST002 to PC WSTCUR01 S 40° 33' 48.59" E Dist 682.2664

Curve Data

Curve WSTCUR01

P.I. Station	=	22+52.88	N	825,593.9462	E	1,946,155.6230
Delta	=	57° 15' 07.97"	(LT)			
Degree	=	11° 27' 32.96"				
Tangent	=	272.9045				
Length	=	499.6198				
Radius	=	500.0000				
External	=	69.6287				
Long Chord	=	479.0919				
Mid. Ord.	=	61.1176				
P.C. Station		19+79.98	N	825,801.2678	E	1,945,978.1559
P.T. Station		24+79.60	N	825,631.0577	E	1,946,425.9924
C.C.			N	826,126.4130	E	1,946,357.9988
Back	= S	40° 33' 48.59"	E			
Ahead	= N	82° 11' 03.44"	E			
Chord Bear	= S	69° 11' 22.58"	E			

Max SE = 6.0%
Design SE = 6.0%

Ending chain WST001P description