

Redfearn, Tyke

From: ARCHIE, ROBERT J <Robert.Archie@scana.com>
Sent: Thursday, November 05, 2015 11:06 AM
To: Mattox, James H.
Cc: Redfearn, Tyke; Bickley, Brooks J.; HOEY, DUSTIN O
Subject: RE: Port Access: Relocation Schedule and Sketch
Attachments: Port Access Rd - Gas Relocation Concept.pdf

Jae,

Attached is a preliminary concept drawing of our gas relocations for this project. Our initial preliminary schedule has us starting construction as early as next April and concluding in October. As discussed, there are several issues that need to be addressed to firm up the final routing and schedule. This information should be considered preliminary and subject to change as the design process progresses.

Thanks,

Justin Archie
SCANA Services
6099 Fain St
North Charleston, SC 29406
Office: (843) 576-8937
Mobile: (803) 206-3652

From: Mattox, James H. [<mailto:MattoxJH@scdot.org>]
Sent: Thursday, November 05, 2015 10:16 AM
To: ARCHIE, ROBERT J
Cc: Redfearn, Tyke; Bickley, Brooks J.
Subject: RE: Port Access: Relocation Schedule and Sketch

*****This is an EXTERNAL email. Please do not click on a link or open any attachments unless you are confident it is from a trusted source.**

perfect

From: ARCHIE, ROBERT J [<mailto:Robert.Archie@scana.com>]
Sent: Thursday, November 05, 2015 10:03 AM
To: Mattox, James H.
Cc: Redfearn, Tyke; Bickley, Brooks J.
Subject: RE: Port Access: Relocation Schedule and Sketch

Jae,

I will have something over to you all before noon today. The schedule will be very preliminary as we need to iron out a lot of details (water main location, Santee Cooper pole placement near Meeting St ramp, etc..).

Thanks,

Justin Archie

SCANA Services
6099 Fain St
North Charleston, SC 29406
Office: (843) 576-8937
Mobile: (803) 206-3652

From: Mattox, James H. [<mailto:MattoxJH@scdot.org>]
Sent: Wednesday, November 04, 2015 7:27 PM
To: ARCHIE, ROBERT J
Cc: Redfearn, Tyke; Bickley, Brooks J.
Subject: Port Access: Relocation Schedule and Sketch

*****This is an EXTERNAL email. Please do not click on a link or open any attachments unless you are confident it is from a trusted source.**

Justin,

As discussed in our meeting last week, can you please provide a preliminary schedule and relocation sketch that we can provide in our Final RFP to let our Proposers have an idea what you guys are planning? We are releasing the Final RFP tomorrow afternoon so we really need this in the morning if at all possible. Call me or Tyke if you have questions or concerns.

Thanks,
Jae

James (Jae) H. Mattox, III, P.E.

Program Manager | SCDOT – Design Build
955 Park Street - Rm 421 - Columbia, SC 29202
803.737.1805 (office) | mattxjh@scdot.org

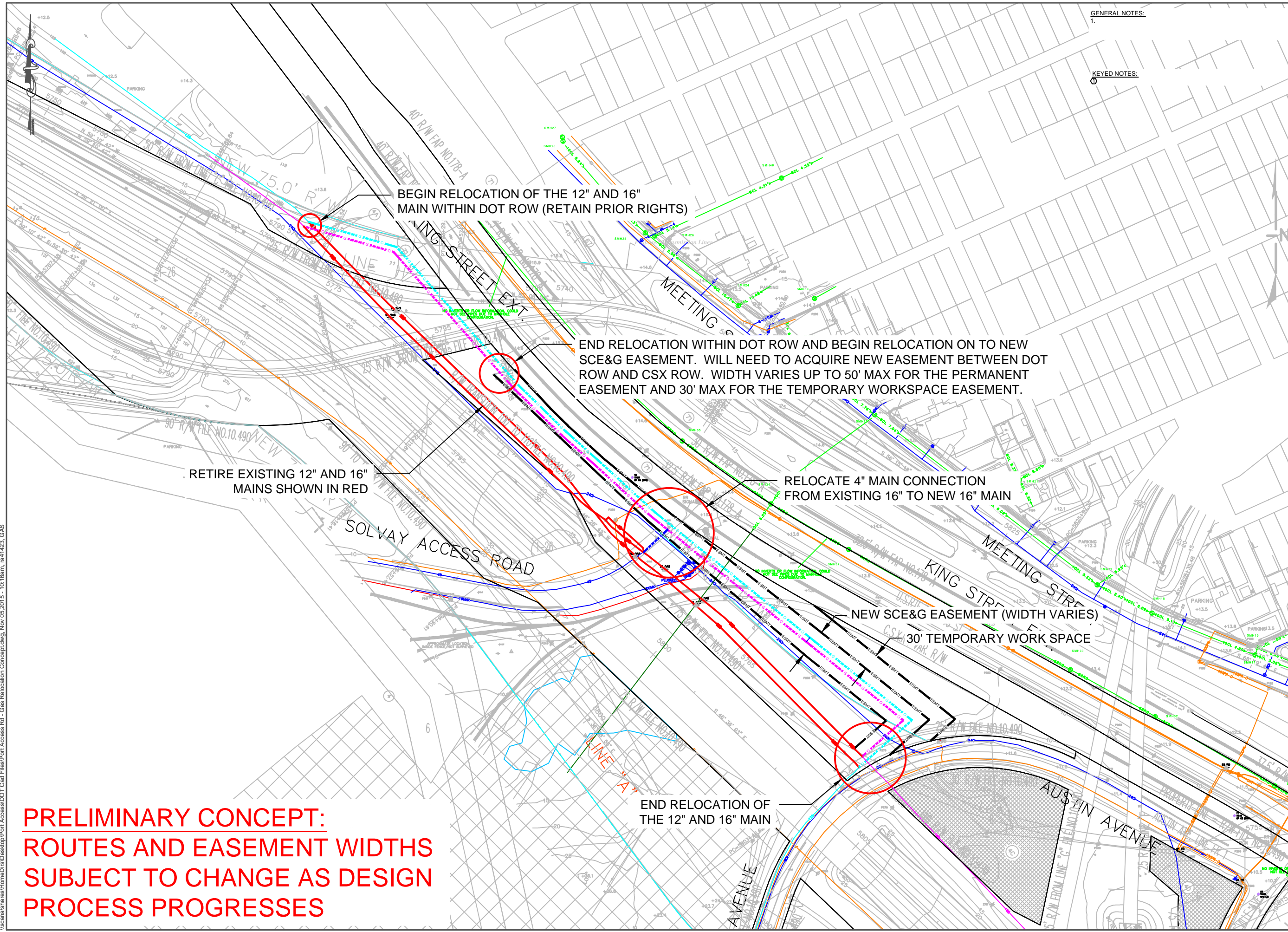

GENERAL NOTES:
1.

KEYED NOTES:
①

BEGIN RELOCATION OF THE 12" AND 16"
MAIN WITHIN DOT ROW (RETAIN PRIOR RIGHTS)

END RELOCATION WITHIN DOT ROW AND BEGIN RELOCATION ON TO NEW
SCE&G EASEMENT. WILL NEED TO ACQUIRE NEW EASEMENT BETWEEN DOT
ROW AND CSX ROW. WIDTH VARIES UP TO 50' MAX FOR THE PERMANENT
EASEMENT AND 30' MAX FOR THE TEMPORARY WORKSPACE EASEMENT.

RETIRE EXISTING 12" AND 16"
MAINS SHOWN IN RED

RELOCATE 4" MAIN CONNECTION
FROM EXISTING 16" TO NEW 16" MAIN

NEW SCE&G EASEMENT (WIDTH VARIES)
30' TEMPORARY WORK SPACE

END RELOCATION OF
THE 12" AND 16" MAIN

**PRELIMINARY CONCEPT:
ROUTES AND EASEMENT WIDTHS
SUBJECT TO CHANGE AS DESIGN
PROCESS PROGRESSES**

| PIPE SUMMARY | | | | |
|--------------|-----|-----|-----|-----|
| | P-1 | P-2 | P-3 | P-4 |
| SIZE: | | | | |
| LJD: | | | | |
| MATERIAL: | | | | |
| GRADE: | | | | |
| SPEC: | | | | |
| WALL / SDR: | | | | |
| COATING: | | | | |
| FOOTAGE: | | | | |
| TEST PRESS: | | | | |
| DSGN PRESS: | | | | |
| MAOP: | | | | |

| | P-5 | P-6 | P-7 | P-8 |
|-------------|-----|-----|-----|-----|
| SIZE: | | | | |
| LJD: | | | | |
| MATERIAL: | | | | |
| GRADE: | | | | |
| SPEC: | | | | |
| WALL / SDR: | | | | |
| COATING: | | | | |
| FOOTAGE: | | | | |
| TEST PRESS: | | | | |
| DSGN PRESS: | | | | |
| MAOP: | | | | |

| NO. | BY | REVISION | DATE | SCALE |
|-----|-----|----------|-----------|-------|
| 1 | | | | 1:160 |
| 2 | | | 11/5/2014 | |
| 3 | RJA | | | |
| 4 | | | | |
| 5 | | | | |
| 6 | | | | |
| 7 | | | | |
| 8 | | | | |
| 9 | | | | |

PROJECT LOCATION: CHARLESTON
SHEET: 1 OF 1
COST CENTER #
REVISION #

PLAN "SAFETY" INTO EVERY JOB

PROJECT NAME: PORT ACCESS RD - GAS RELOCATION
DRAWING TYPE: PRELIMINARY CONCEPT
DIVISION/DISTRICT: SOUTHERN PROJECT ID #: 62704 WORK ORDER #: 27107
NOT RESPONSIBLE FOR ACCURACY

I:\scana\hates\Home\Dir\Desktop\Port Access\DOT Cat Files\Port Access Rd - Gas Relocation Concept.dwg, Nov 05, 2015 - 10:16am, rja41423, GAS