

**MEMORANDUM OF AGREEMENT BETWEEN
THE FEDERAL HIGHWAY ADMINISTRATION,
THE SOUTH CAROLINA DEPARTMENT OF TRANSPORTATION,
AND THE UNITED STATES FISH AND WILDLIFE SERVICE**

REGARDING THE REPLACEMENT OF THE US 701 BRIDGES OVER THE GREAT PEE
DEE RIVER, THE GREAT PEE DEE RIVER OVERFLOW, AND YAUHANNAH LAKE
GEORGETOWN AND HORRY COUNTIES, SOUTH CAROLINA; FEDERAL PROJECT
NUMBER BR88(044)

WHEREAS, the South Carolina Department of Transportation (SCDOT), with the assistance of Federal-aid funds administered by the Federal Highway Administration (FHWA), proposes to replace the US 701 Bridges over the Great Pee Dee River, the Great Pee Dee River Overflow, and Yauhannah Lake in Georgetown and Horry Counties; and

WHEREAS, the existing bridges are located within the SCDOT's right of way and adjacent to the Waccamaw National Wildlife Refuge (NWR), a property owned by the United States, under the jurisdiction of the United States Fish and Wildlife Service (USFWS); and

WHEREAS, there are conflicting documentations defining the limits of the SCDOT right of way and the NWR property within the limits of the project, and

WHEREAS, the US 701 bridges are in structurally deficient condition and must be replaced immediately for the safety of the travelling public, and

WHEREAS, an Environmental Assessment (EA) document must be prepared, processed and approved before the design and construction of the US 701 facility can begin, and

WHEREAS, a critical component of the NEPA process and preparation of the EA is the determination and evaluation of impacts this project may have on the environment and surrounding properties, including the Section 4(f) and Section 6(f) impacts on the NWR property, and

NOW, THEREFORE, for the limited purpose of expediting the necessary environmental review the FHWA, the SCDOT, and the USFWS agree that the Section 4(f) and Section 6(f) impacts on the NWR property will be calculated and assessed in accordance with the following stipulations:

I. STIPULATIONS

- A. The following stipulations will enable the FHWA and the SCDOT to compute and assess the worst case Section 4(f) and Section 6(f) impacts on the USFWS properties as part of the environmental review process described above.
- B. **USA Tract 30 (SCDOT Tract 9) in Georgetown County** - The USFWS property line along US 701 as defined in the deed recorded in the County of Georgetown will be accepted. Total Acreage of Tract is approximately 31.4 acres.

- C. **USA Tract 11 (SCDOT Tract 18) in Georgetown County** – Approximately 120 ft wide narrow strip lying in the southeast quadrant where US 701 crosses Yauhannah Lake will be considered to be owned by US FWS. SCDOT right of way along this property will be limited to a 100 ft width downstream of the existing centerline of US 701. Total acreage of Tract is included in the total for U.S.A. Tracts 10a, 10b (SCDOT Tract 17).
- D. **USA Tract 17p (SCDOT Tract 16) in Georgetown County** – The USFWS property line along US 701 will be accepted. SCDOT right of way along this property will vary. Total Acreage of Tract is approximately 331.65 acres.
- E. **USA Tracts 10a, 10b (SCDOT Tract 17) in Georgetown County** – A 200 ft wide (100 ft upstream and 100 ft downstream) SCDOT right of way will be accepted. When combined with U.S.A. Tract 11 (SCDOT Tract 18), total acreage is approximately 1,299.57 acres.
- F. **USA Tracts 17m, 17n (SCDOT Tracts 19, 20) in Horry County** – A 400 ft (250 ft upstream and 150 ft downstream) SCDOT right of way will be accepted. When adjusted to account for the SCDOT right-of-way, total acreage of is approximately 461.66 acres.

II. Limitations of the Above Stipulations

The above stipulations will be valid only for the purpose of computing the Section 4(f) and Section 6(f) impacts on the USFWS properties in the vicinity of the US 701 project and reflects a worst case scenario in terms of impacts. The parties agree that no express or implied admission of legal title to any property interest is intended by these stipulations and these stipulations will not be valid to prepare the right of way acquisition calculations.

SIGNATORIES:

Federal Highway Administration

By: 
Mr. Robert L. Lee, Division Administrator

Date: 5/14/12

South Carolina Department of Transportation

By: 
Mr. Randall D. Williamson, Environmental Engineer

Date: May 2, 2012

United States Fish and Wildlife Service

By: 
Ms. Cynthia Donner, Southeast Regional Director

Date: June 21, 2012

Exhibit A

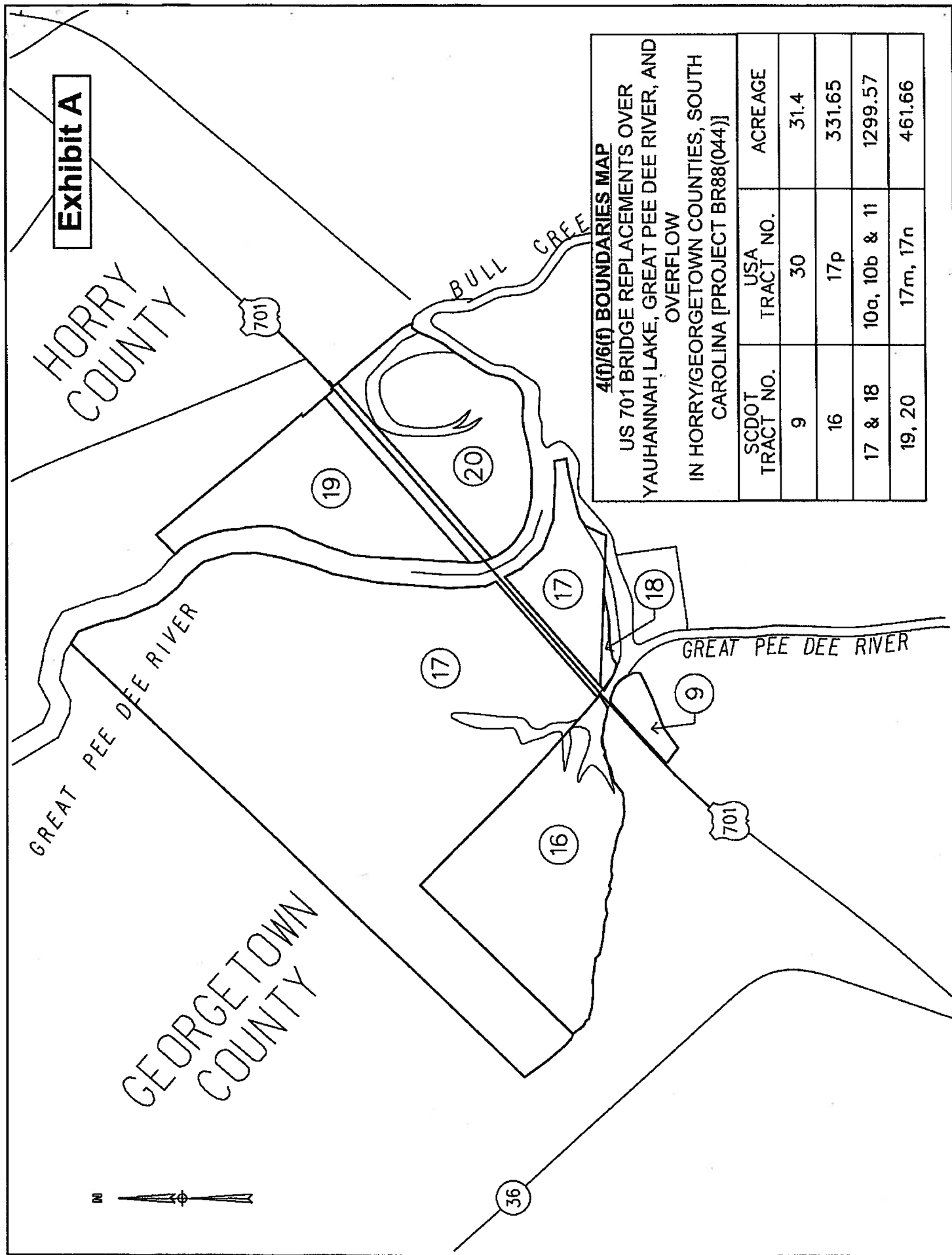

4(f)(6)(f) BOUNDARIES MAP

US 701 BRIDGE REPLACEMENTS OVER
YAUHANNAH LAKE, GREAT PEE DEE RIVER, AND
OVERFLOW
IN HORRY/GEORGETOWN COUNTIES, SOUTH
CAROLINA [PROJECT BR88(044)]

SCDOT TRACT NO.	USA TRACT NO.	ACREAGE
9	30	31.4
16	17p	331.65
17 & 18	10a, 10b & 11	1299.57
19, 20	17m, 17n	461.66

