

FED. RD. DIST. NO.	STATE	COUNTY	PROJECT ID	ROUTE NO.	SHEET NO.
3	S.C.	NEWBERRY		US 176	TC 1

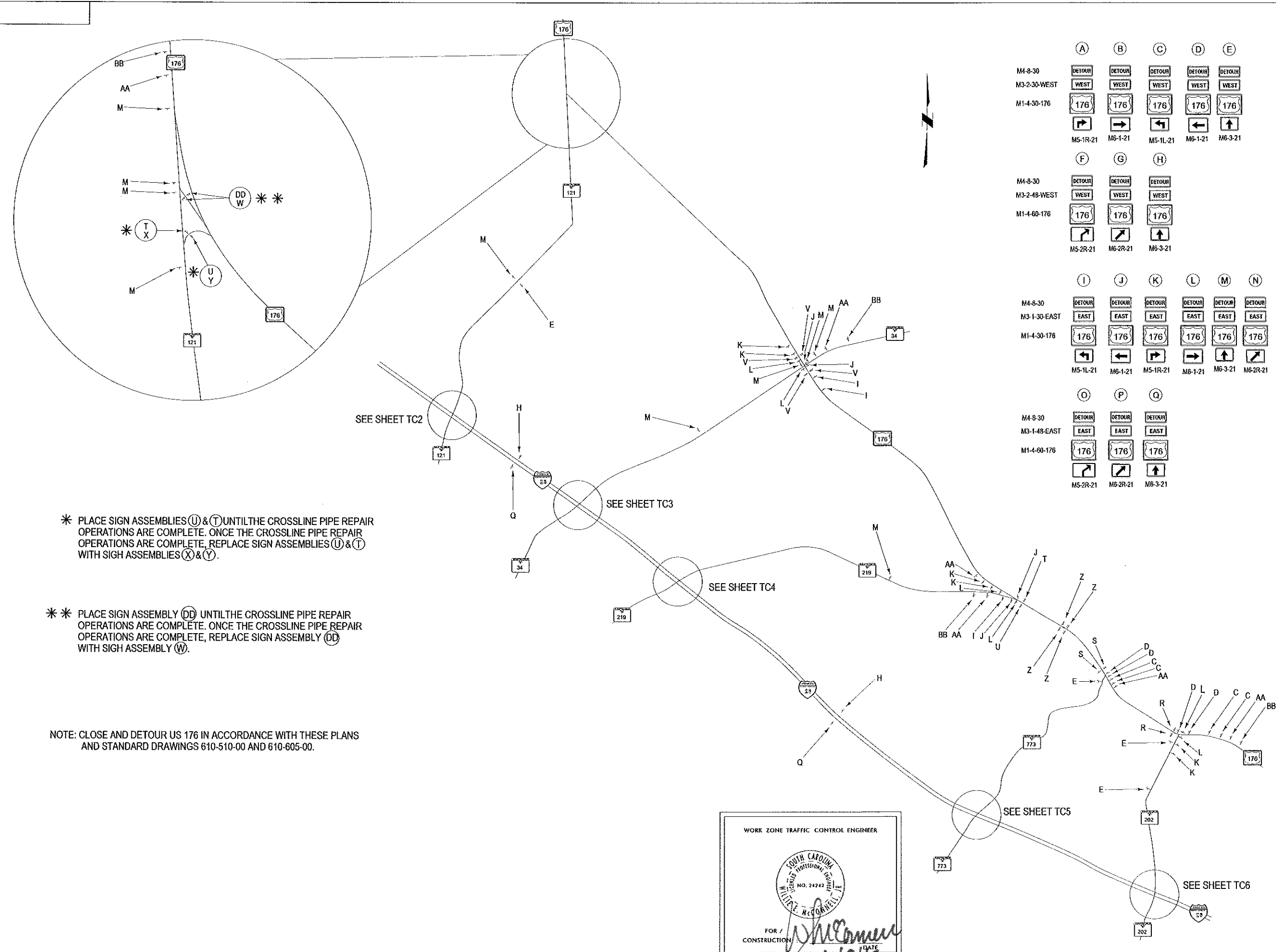

	(A)	(B)	(C)	(D)	(E)	
M4-8-30	DETOUR	DETOUR	DETOUR	DETOUR	DETOUR	
M3-2-30-WEST	WEST	WEST	WEST	WEST	WEST	
M1-4-30-176	176	176	176	176	176	
M5-1R-21	→	→	←	←	↑	
M6-1-21						
M5-1L-21						
M6-1-21						
M6-3-21						
	(F)	(G)	(H)			
M4-8-30	DETOUR	DETOUR	DETOUR			
M3-2-48-WEST	WEST	WEST	WEST			
M1-4-60-176	176	176	176			
M5-2R-21	→	→	↑			
M6-2R-21						
M6-3-21						
	(I)	(J)	(K)	(L)	(M)	(N)
M4-8-30	DETOUR	DETOUR	DETOUR	DETOUR	DETOUR	DETOUR
M3-1-30-EAST	EAST	EAST	EAST	EAST	EAST	EAST
M1-4-30-176	176	176	176	176	176	176
M5-1L-21	←	←	→	→	↑	↗
M6-1-21						
M5-1R-21						
M6-1-21						
M6-3-21						
M6-2R-21						
	(O)	(P)	(Q)			
M4-8-30	DETOUR	DETOUR	DETOUR			
M3-1-48-EAST	EAST	EAST	EAST			
M1-4-60-176	176	176	176			
M5-2R-21	→	↗	↑			
M6-2R-21						
M6-3-21						

(R)	(S)	
R11-3A-60-2.50	R11-3A-60-1.00	
M4-10L-48	M4-10L-48	
(T)	(U)	
R11-3A-60-1.00	R11-3A-60-1.00	
(V)	(W)	
R11-3A-60-6.50	R11-3A-60-12.50	
M4-10R-48	M4-10R-48	
(X)	(Y)	
R11-3A-60-12.50	R11-3A-60-12.50	
(Z)	(AA)	(BB)
	DETOUR 1500 FT	ROAD CLOSED AHEAD
	W20-2-48-15	W20-3-48-A
(CC)	(DD)	
M4-8-30	DETOUR	
M3-1-30-EAST	EAST	
M1-4-30-176	176	
M5-2R-21	→	
(DD)		
R11-3A-60-1.00	ROAD CLOSED FOR REPAIR LOCAL TRAFFIC ONLY	
M4-10R-48	DETOUR	

* PLACE SIGN ASSEMBLIES (U) & (T) UNTIL THE CROSSLINE PIPE REPAIR OPERATIONS ARE COMPLETE. ONCE THE CROSSLINE PIPE REPAIR OPERATIONS ARE COMPLETE, REPLACE SIGN ASSEMBLIES (U) & (T) WITH SIGN ASSEMBLIES (X) & (Y).

* * PLACE SIGN ASSEMBLY (DD) UNTIL THE CROSSLINE PIPE REPAIR OPERATIONS ARE COMPLETE. ONCE THE CROSSLINE PIPE REPAIR OPERATIONS ARE COMPLETE, REPLACE SIGN ASSEMBLY (DD) WITH SIGN ASSEMBLY (W).

NOTE: CLOSE AND DETOUR US 176 IN ACCORDANCE WITH THESE PLANS AND STANDARD DRAWINGS 610-510-00 AND 610-605-00.

WORK ZONE TRAFFIC CONTROL ENGINEER

SOUTH CAROLINA
REGISTERED PROFESSIONAL ENGINEER
NO. 24242
WILLIAM M. McCOMBELL, P.E.

FOR / CONSTRUCTION *William McCombell* DATE 10/9/15

SOUTH CAROLINA
DEPARTMENT OF TRANSPORTATION
TRAFFIC ENGINEERING - COLUMBIA, S.C.

US 176
DETOUR PLAN

SCALE 1" = NTS RTE. US 176 DWG. NO. TC 1

\$\$\$\$\$USER\$\$\$\$\$
\$\$\$\$\$DOT\$\$\$\$\$
\$\$\$\$\$FILENAME\$\$\$\$\$
\$\$\$\$\$DATE\$\$\$\$\$

FED. PROJ. NO.	STATE	COUNTY	PROJECT #	ROUTE NO.	SHEET NO.
3	S.C.	NEWBERRY		US 176	TC 2

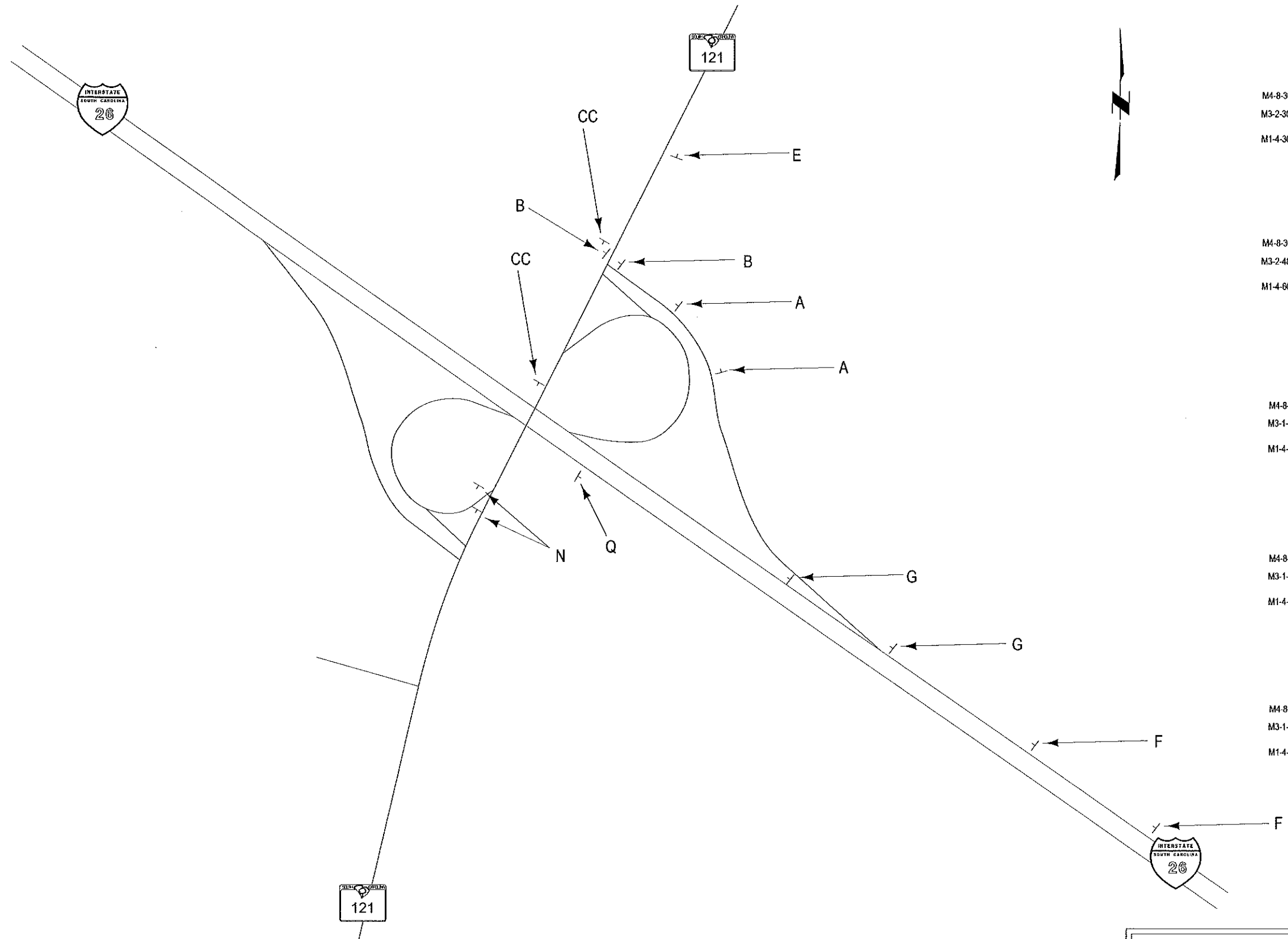

- (A) M4-8-30 [DETOUR] M3-2-30-WEST [WEST] M1-4-30-176 [176] M5-1R-21 [RIGHT] M6-1-21 [RIGHT] M6-3-21 [UP]
- (B) M4-8-30 [DETOUR] M3-2-48-WEST [WEST] M1-4-60-176 [176] M5-2R-21 [RIGHT] M6-2R-21 [RIGHT]
- (E) M4-8-30 [DETOUR] M3-1-30-EAST [EAST] M1-4-30-176 [176] M5-1R-21 [RIGHT] M6-2R-21 [RIGHT]
- (F) M4-8-30 [DETOUR] M3-1-48-EAST [EAST] M1-4-60-176 [176] M6-3-21 [UP]
- (G) M4-8-30 [DETOUR] M3-1-30-EAST [EAST] M1-4-30-176 [176] M5-2R-21 [RIGHT]
- (N) M4-8-30 [DETOUR] M3-1-30-EAST [EAST] M1-4-30-176 [176] M5-2R-21 [RIGHT]
- (Q) M4-8-30 [DETOUR] M3-1-30-EAST [EAST] M1-4-30-176 [176] M5-2R-21 [RIGHT]
- (CC) M4-8-30 [DETOUR] M3-1-30-EAST [EAST] M1-4-30-176 [176] M5-2R-21 [RIGHT]

WilliamsCI
 \\nfs\hq\TE-Trans\Design\TE-Wrk-Zn\Chris\Newberry\US 176 Bridge Detour.dgn
 09-OCT-2015

WORK ZONE TRAFFIC CONTROL ENGINEER

 FOR CONSTRUCTION *W. McQueen*
 DATE *10/9/15*

SOUTH CAROLINA
 DEPARTMENT OF TRANSPORTATION
 TRAFFIC ENGINEERING - COLUMBIA, S.C.

US 176
 DETOUR PLAN

FED. RD. DIST. NO.	STATE	COUNTY	PROJECT ID	ROUTE NO.	SHEET NO.
5	S.C.	NEWBERRY		US 176	TC 3

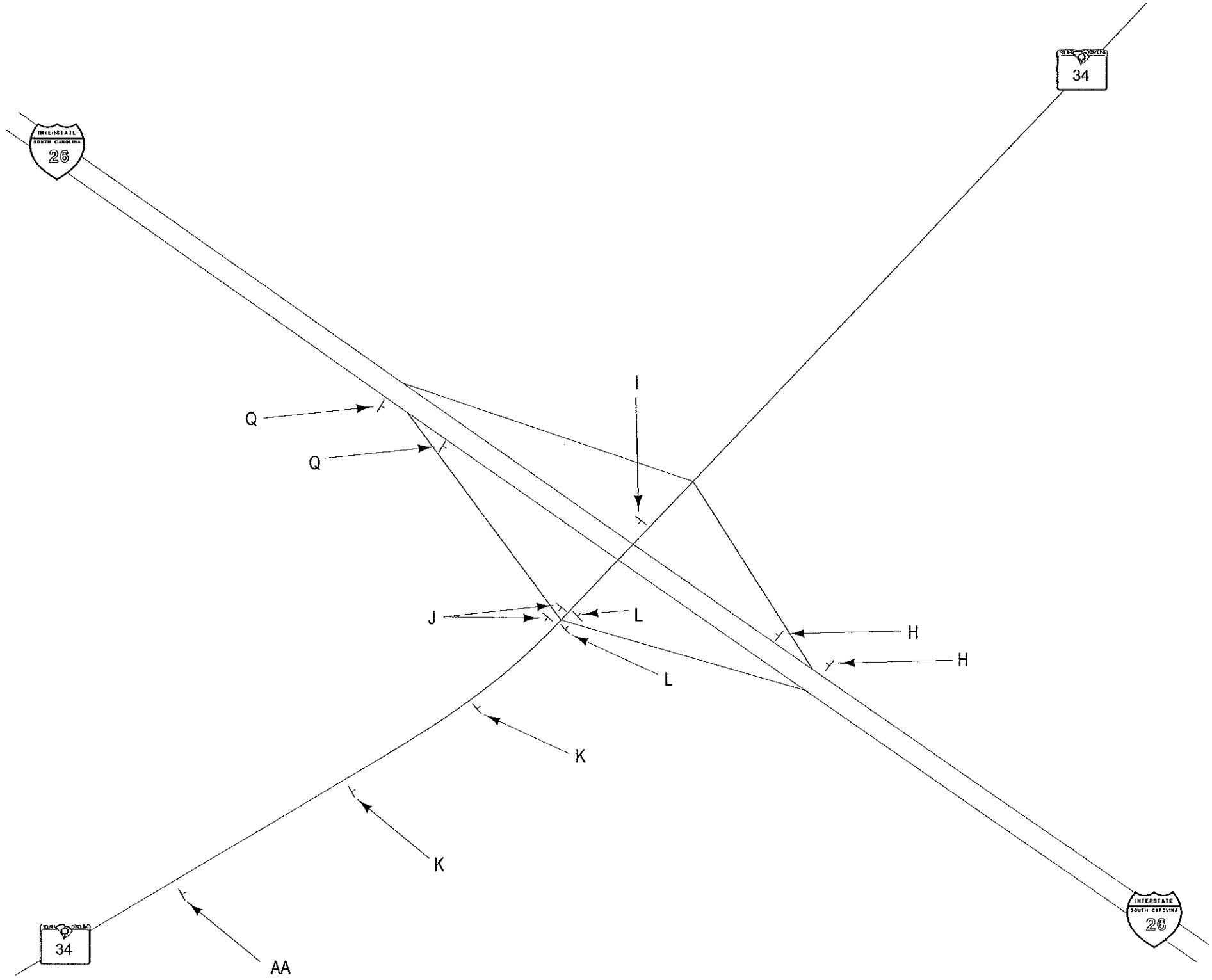

- (H)
 - M4-8-30 [DETOUR]
 - M3-2-48-WEST [WEST]
 - M1-4-60-176 [176]
 - [↑] M6-3-21

- (I) [DETOUR] M4-8-30
 - [EAST] M3-1-30-EAST
 - [176] M1-4-30-176
 - [↶] M5-1L-21
- (J) [DETOUR]
 - [EAST] M3-1-30-EAST
 - [176] M1-4-30-176
 - [←] M6-1-21
- (K) [DETOUR]
 - [EAST] M3-1-48-EAST
 - [176] M1-4-60-176
 - [↷] M5-1R-21
- (L) [DETOUR]
 - [EAST] M3-1-30-EAST
 - [176] M1-4-30-176
 - [→] M6-1-21

- (Q)
 - [DETOUR] M4-8-30
 - [EAST] M3-1-48-EAST
 - [176] M1-4-60-176
 - [↑] M6-3-21
- (AA)
 - [DETOUR 1500 FT] W20-2-48-15

\\nts\baq\TE\TE-Tr of-Dsgn\TE-Wrk-Zn\Chris\Newberry\US 176 Bridge Detour.dgn
 09-0CT-2015
 WilliamsCI

WORK ZONE TRAFFIC CONTROL ENGINEER

FOR / CONSTRUCTION *W. Connell*

DATE 10/9/15

SOUTH CAROLINA
 DEPARTMENT OF TRANSPORTATION
 TRAFFIC ENGINEERING - COLUMBIA, S.C.

US 176
 DETOUR PLAN

SCALE 1"= NTS RTE. US 176 DWG. NO. TC 3

FED. RD. DIST. NO.	STATE	COUNTY	PROJECT ID	ROUTE NO.	SHEET NO.
3	S.C.	NEWBERRY		US 176	TC 4

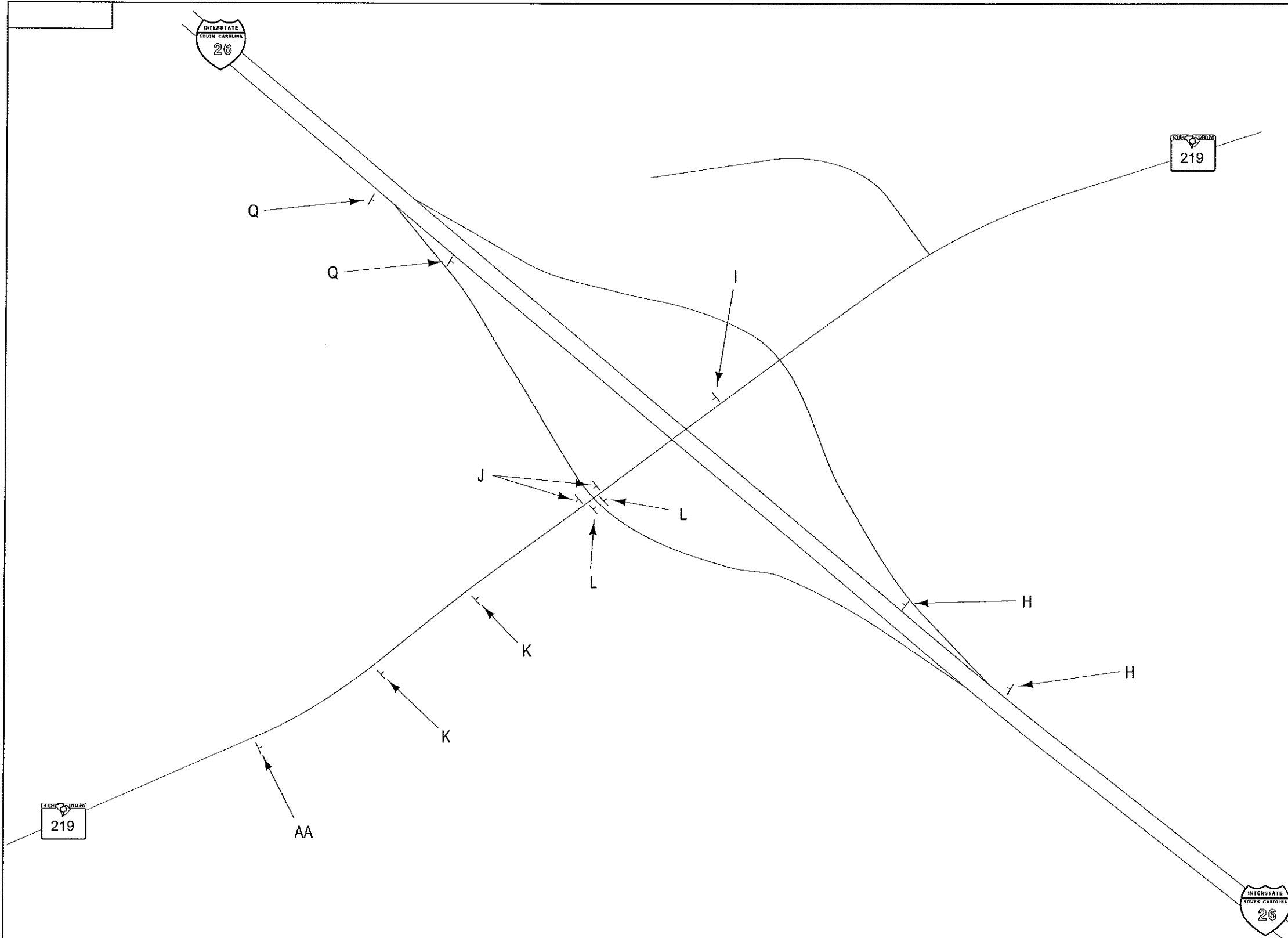

- (H)
- M4-8-30 [DETOUR]
- M3-2-48-WEST [WEST]
- M1-4-60-176 [176]
- [↑]
- M6-3-21

- (I) (J) (K) (L)
- M4-8-30 [DETOUR] [DETOUR] [DETOUR] [DETOUR]
- M3-1-30-EAST [EAST] [EAST] [EAST] [EAST]
- M1-4-30-176 [176] [176] [176] [176]
- [←] [←] [→] [→]
- M5-1L-21 M6-1-21 M5-1R-21 M6-1-21

- (Q) (AA)
- M4-8-30 [DETOUR] [DETOUR 1500 FT.]
- M3-1-48-EAST [EAST]
- M1-4-60-176 [176]
- [↑]
- M6-3-21
- W20-2-48-15

WilliamsCL
 \nfts\hq\TE-1\rof-Dison\TE-Wrk-Zn\Chris Newberry\US 176 Bridge Detour.dgn
 09-OCT-2015

WORK ZONE TRAFFIC CONTROL ENGINEER

 FOR / CONSTRUCTION *Willie E. McConnell*
 DATE 10/9/15

SOUTH CAROLINA
 DEPARTMENT OF TRANSPORTATION
 TRAFFIC ENGINEERING - COLUMBIA, S.C.

 US 176
 DETOUR PLAN

 SCALE 1"= NTS RTE. US 176 DWG. NO. TC 4

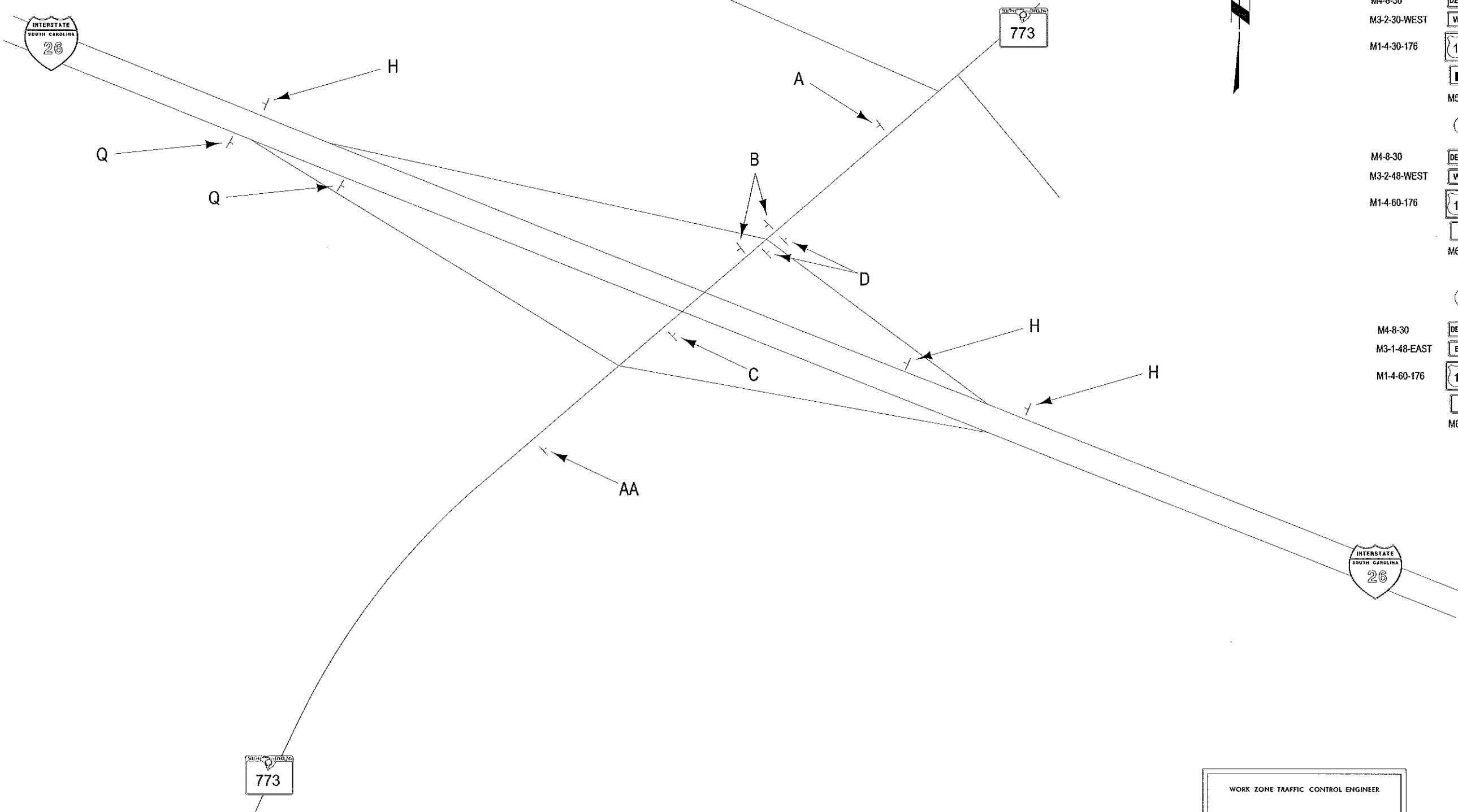
FED. RD. DIST. NO.	STATE	COUNTY	PROJECT ID	ROUTE NO.	SHEET NO.
5	S.C.	NEWBERRY		US 176	TC 5



- | | (A) | (B) | (C) | (D) |
|--------------|--------|---------|----------|---------|
| M4-8-30 | DETOUR | DETOUR | DETOUR | DETOUR |
| M3-2-30-WEST | WEST | WEST | WEST | WEST |
| M1-4-30-176 | 176 | 176 | 176 | 176 |
| | → | → | ← | ← |
| M5-1R-21 | | M6-1-21 | M5-1L-21 | M6-1-21 |
- | | (H) |
|--------------|--------|
| M4-8-30 | DETOUR |
| M3-2-48-WEST | WEST |
| M1-4-60-176 | 176 |
| | ↑ |
| M6-3-21 | |
- | | (Q) | (AA) |
|--------------|--------|------|
| M4-8-30 | DETOUR | |
| M3-1-48-EAST | EAST | |
| M1-4-60-176 | 176 | |
| | ↑ | |
| M6-3-21 | | |

\$\$\$\$\$PATH\$\$\$\$\$FILENAME\$\$\$\$\$

WORK ZONE TRAFFIC CONTROL ENGINEER

FOR / CONSTRUCTION: *Willie E. McConnell*

SOUTH CAROLINA
DEPARTMENT OF TRANSPORTATION
TRAFFIC ENGINEERING - COLUMBIA, S.C.

US 176
DETOUR PLAN

SCALE 1" = NTS RTE. US 176 DWG. NO. TC 5

FED. DIST. DIST. NO.	STATE	COUNTY	PROJECT #	ROUTE NO.	SHEET NO.
3	S.C.	NEWBERRY		US 176	TC 6



- (A) M4-8-30 [DETOUR] [DETOUR]
- M3-2-30-WEST [WEST] [WEST]
- M1-4-30-176 [176] [176]
- [Right Arrow] [Right Arrow]
- M5-1R-21 M6-1-21
- (B) M4-8-30 [DETOUR]
- M3-2-48-WEST [WEST]
- M1-4-60-176 [176]
- [Up Arrow] M6-3-21
- (H) M4-8-30 [DETOUR]
- M3-1-30-EAST [EAST] [EAST]
- M1-4-30-176 [176] [176] [176]
- [Left Arrow] [Left Arrow] [Up Arrow]
- M5-1L-21 M6-1-21 M6-3-21
- (I) M4-8-30 [DETOUR] [DETOUR]
- M3-1-48-EAST [EAST] [EAST]
- M1-4-60-176 [176] [176]
- [Right Arrow] [Right Arrow]
- M5-2R-21 M6-2R-21
- (J) M4-8-30 [DETOUR] [DETOUR]
- M3-1-30-EAST [EAST] [EAST]
- M1-4-30-176 [176] [176]
- [Left Arrow] [Left Arrow]
- M5-1L-21 M6-1-21
- (M) M4-8-30 [DETOUR] [DETOUR]
- M3-1-48-EAST [EAST] [EAST]
- M1-4-60-176 [176] [176]
- [Right Arrow] [Right Arrow]
- M5-2R-21 M6-2R-21

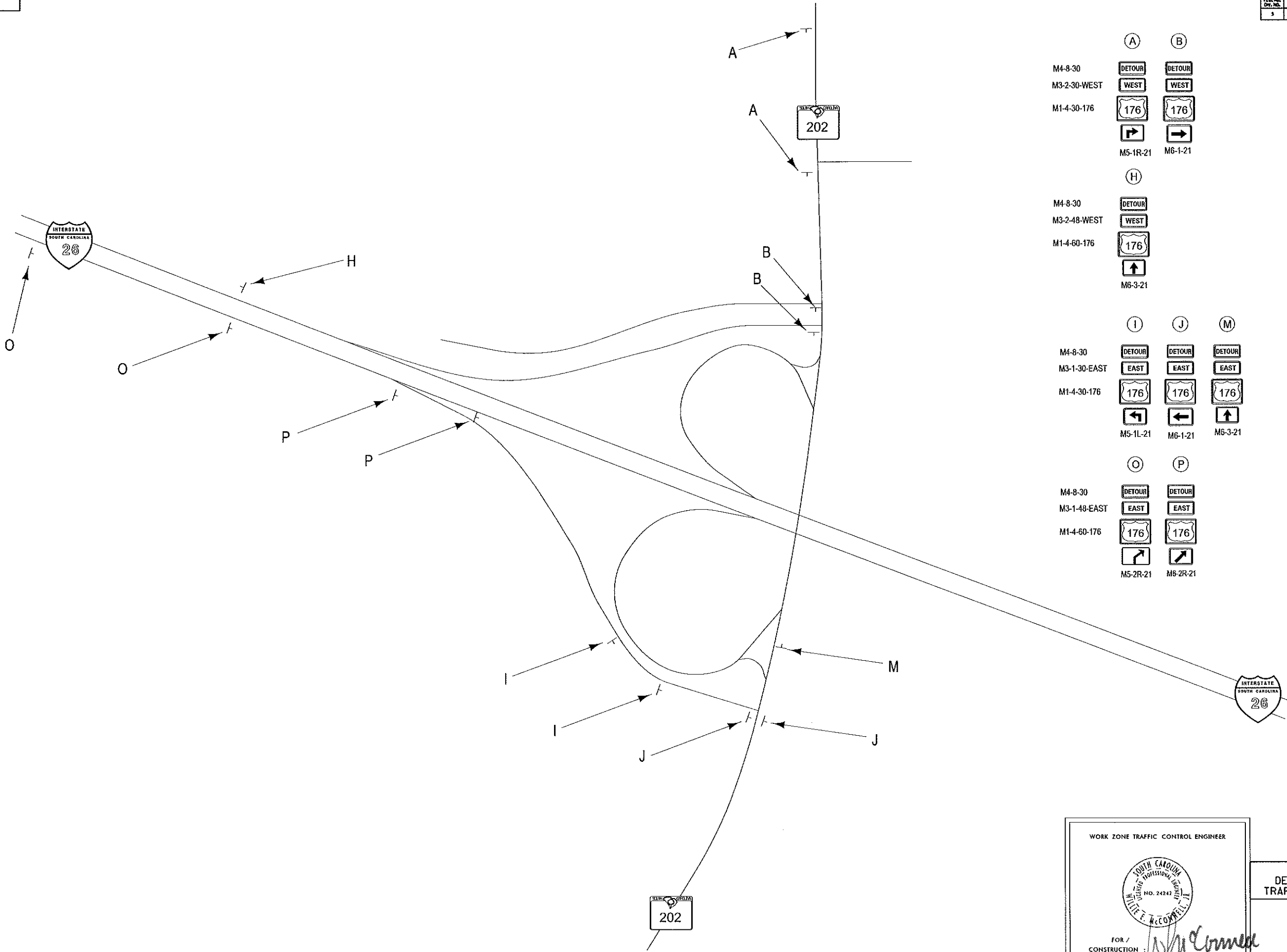

WilliamsCL
 \\nfs\hq\TE-Traf-Disp\TE-Wrk-Zn\Chris\Newberry\US 176 Bridge Detour.dgn
 09-OCT-2015

WORK ZONE TRAFFIC CONTROL ENGINEER

FOR / CONSTRUCTION : *W. E. McCombe* DATE: *10/9/15*

SOUTH CAROLINA
 DEPARTMENT OF TRANSPORTATION
 TRAFFIC ENGINEERING - COLUMBIA, S.C.

US 176
 DETOUR PLAN

SCALE 1"= NTS RTE. US 176 DWG. NO. TC 6